

GENERAL ASSEMBLY INSTRUCTIONS FOR LOG CABINS WITH STEEL PITCHED ROOFS

This brochure has been compiled for all our log cabins with steel pitched roofs.
The drawings may differ from the log cabin you have purchased.

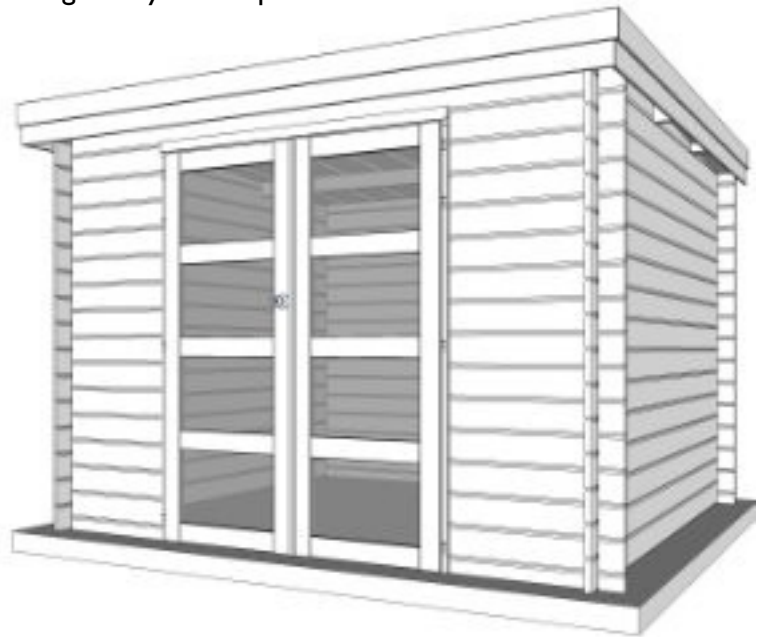

GARDENAS

TIMBER GARDEN CONSTRUCTIONS



GENERAL ASSEMBLY INSTRUCTIONS FOR LOG CABINS WITH STEEL PITCHED ROOF

Congratulations on the purchase of your log cabin.

If you read the assembly instructions carefully, you will enjoy your purchase for many years to come.

IMPORTANT!

Before you start assembly, we would like to give you some important information that deserves your attention.

A You have purchased a log cabin made from an untreated natural product. The wood still needs to be treated to ensure a long lifespan. It is best to seek advice from a specialist when choosing your treatment product and for the maintenance of your log cabin. Use only products that penetrate the wood and protect it against moisture, wind and weather, as well as against insects and fungi. Do not use products that are so viscous that they prevent a good fit between the tongue and groove and the corner joints. You only have the opportunity to treat the tongue and groove **before** assembly. It is very important **to treat** all parts **on all sides**. You must therefore also treat **the inside** of the log cabin.

B It is advisable to install a waterproof concrete base that is 10 cm larger than the outer dimensions of the log cabin. It is of the utmost importance that your log cabin is level and remains so. Bear in mind that if your structure does not remain level after installation, gaps and deformations may occur in the log cabin. Ensure that ground moisture and other moisture cannot penetrate the wood by providing adequate ventilation for the log cabin and treating **the interior** against moisture. The bottom logs of your log cabin deserve extra attention, as they will be most exposed to water. Therefore, treat them with extra care. Seal the joint between the log cabin and its base with silicone (not included). Anchor your log cabin to its base (e.g. using L-brackets, not included) to protect it against stormy weather.

C "Wood lives" – a saying that also applies to your purchase. In practical terms, this means that the height of the log cabin will vary depending on the humidity. If you install any vertical or horizontal structures (e.g. shelving, electrical wiring, storm braces, etc.), you must ensure that you do not impede this natural movement of the wood. If you connect the wood vertically in certain places, gaps will appear between your logs during periods of low humidity, often resulting in deformation of the log cabin. Furthermore, do not be alarmed if you notice a gap above the door and window during the assembly of your log cabin. These gaps are specifically designed to accommodate shrinkage and expansion. We supply matching cover strips to conceal this gap.

D Remove the parts of your log cabin from their packaging two days before assembly. This allows the wood to acclimatise to the humidity. Place the logs slightly apart, sheltered from rain and sun. Now carry out a full check using the enclosed parts list. Complaints regarding materials will not be accepted if the parts have been painted. Complaints must reach us no later than 8 days after delivery.

E Wood is a natural product. This means that slight variations may occur. What are **acceptable** variations?

- Knots,
- Fallen knots no larger than a thumb,
- Fallen knots or slight damage to the edges (tongue and groove) if coverage is guaranteed during assembly,
- Discolouration in the wood,
- Straight cracks that do not split the log, splitting cracks no longer than 12 cm,
- Resin pockets of up to 5 cm,
- Wood that is slightly bowed, if assembly remains possible (the pressure from the roof will usually keep the log straight).

F Ensure your log cabin is **anchored** to its base (e.g. L-bracket, not supplied). Also ensure effective vertical storm bracing that takes into account the tips mentioned in point C "Wood lives". Gardenas dealers sell our special storm bracing kits.

G When assembling the walls, do not use nails or screws. The pressure of the roof, combined with the storm bracing, will ensure that your log cabin remains standing. To prevent splitting, we recommend that you pre-drill with a drill bit whose diameter is smaller than that of the screw.

H Has a part been damaged during installation, or are you having trouble figuring it out?

Our after-sales service is at your disposal:

- during office hours by telephone: +32 (0)52 21 95 71
- by fax: +32 (0)52 22 09 03 or
- by email info@gardenas.be
- If you notice any damage to the parcel, please let us know within 48 hours.

Once you have checked the package using the accompanying parts list, you can start assembly.
What do you need? A saw, a try-square, a piece of auxiliary wood, a screwdriver (preferably battery-powered or electric), 2 ladders, a rubber mallet, a drill, silicone. At least 2 adults are required for the assembly. Keep children and pets away during assembly.

We recommend sorting the parts by wall before assembly. Ensure there is sufficient space for assembly. Please also refer to the plans on page 3 of the parts list.

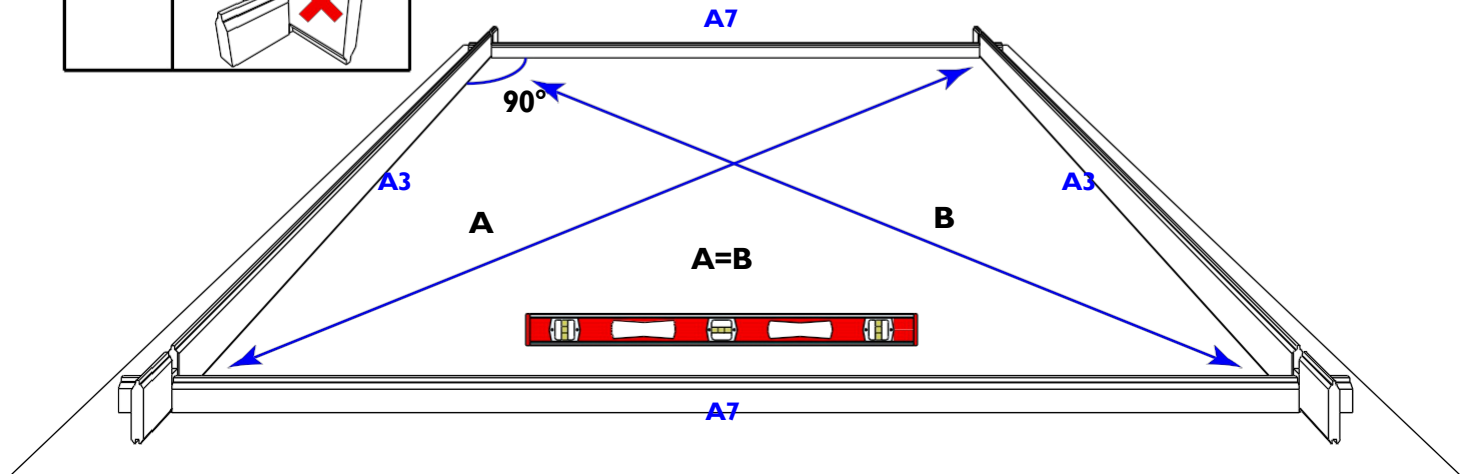
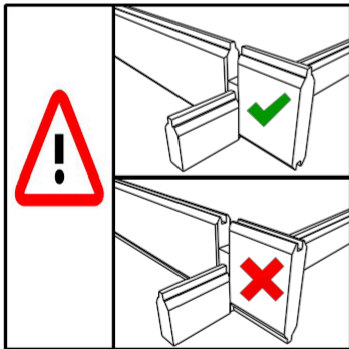

2.

If the door is not in the middle of the model, you can choose which side to place the door on. **Caution:** install the **angle brackets** first, then **cut**. The piece you cut off is waste. **Never** install this above the door! For the rest of the assembly, please also refer to the wall Plans in the parts list.

To ensure everything is square, you must anchor **each** bottom log to the base using angle brackets and concrete plugs (not supplied). Gardena dealers sell a special storm bracing kit for this purpose.

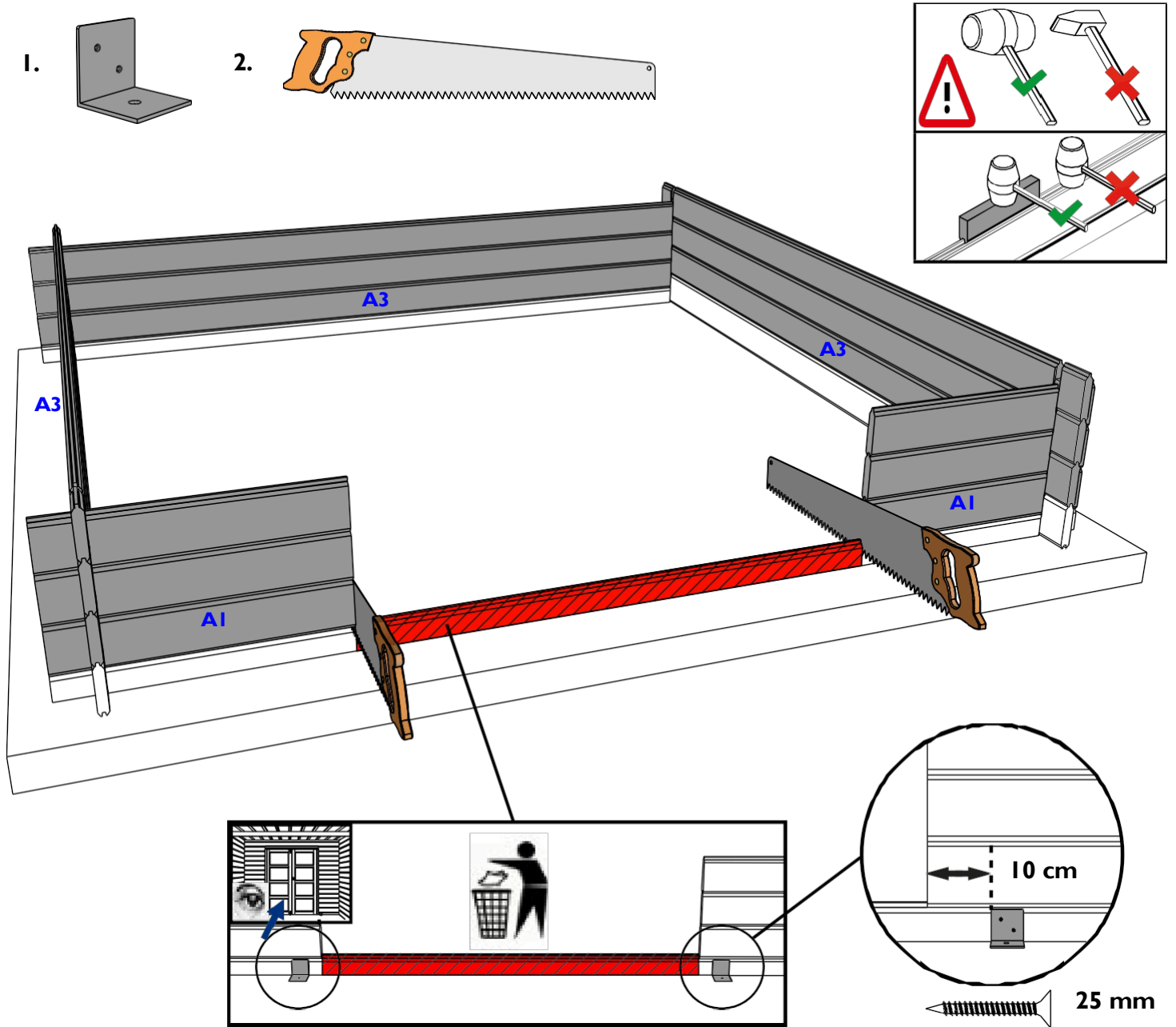

If a warped/crooked log does not fit:

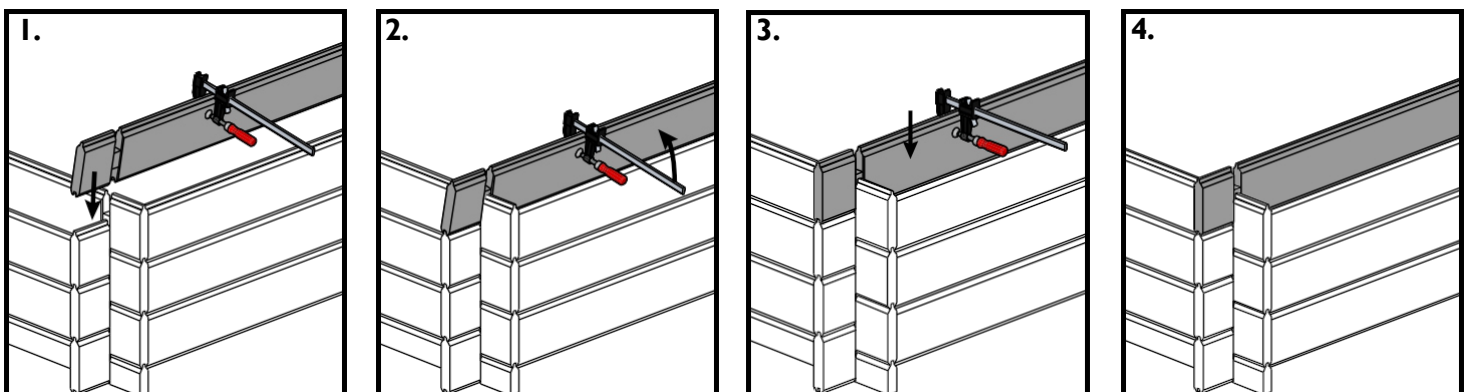

3.

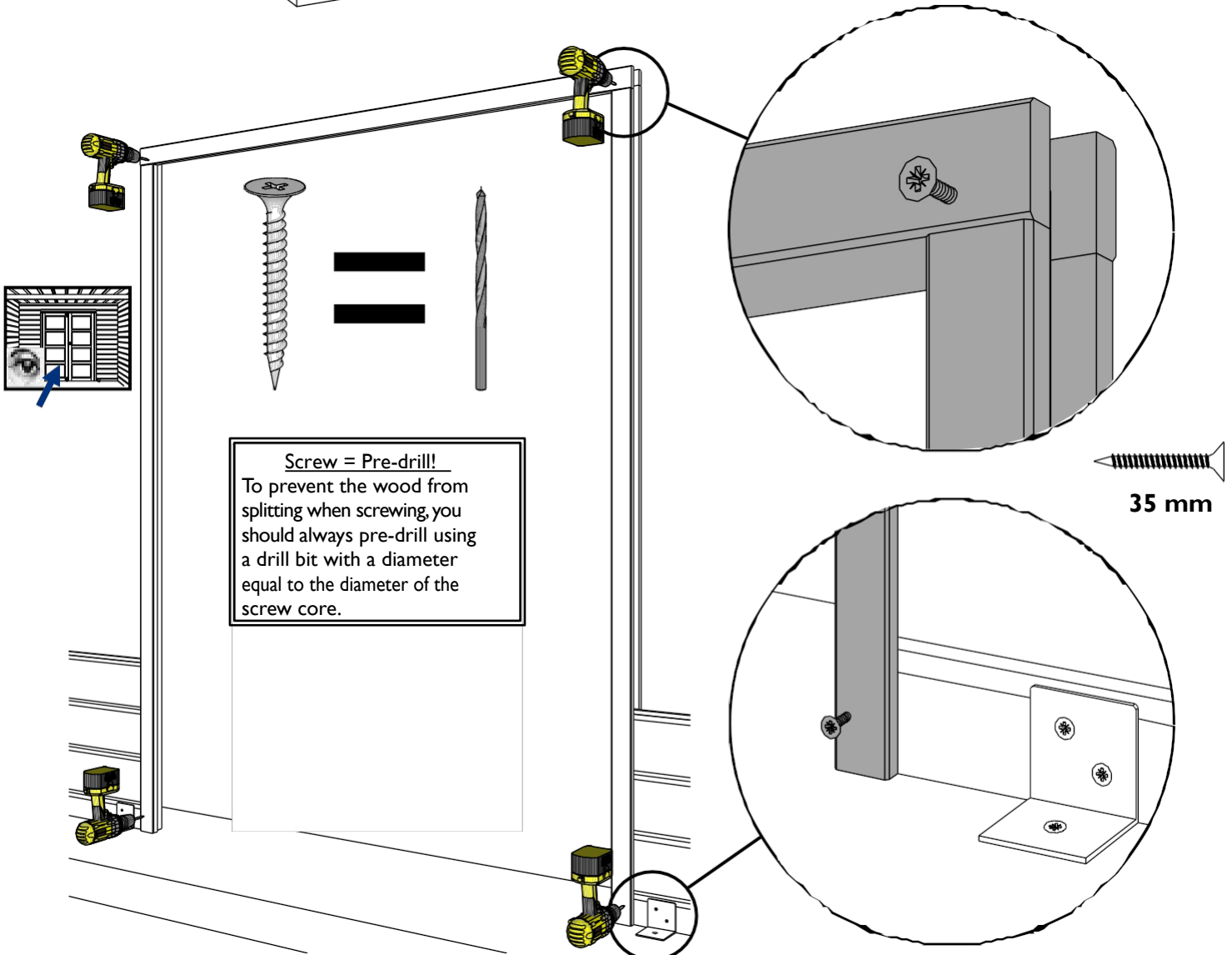
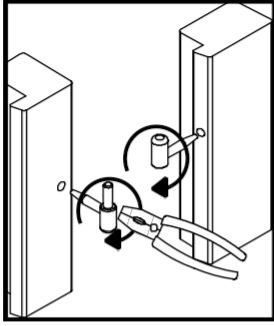
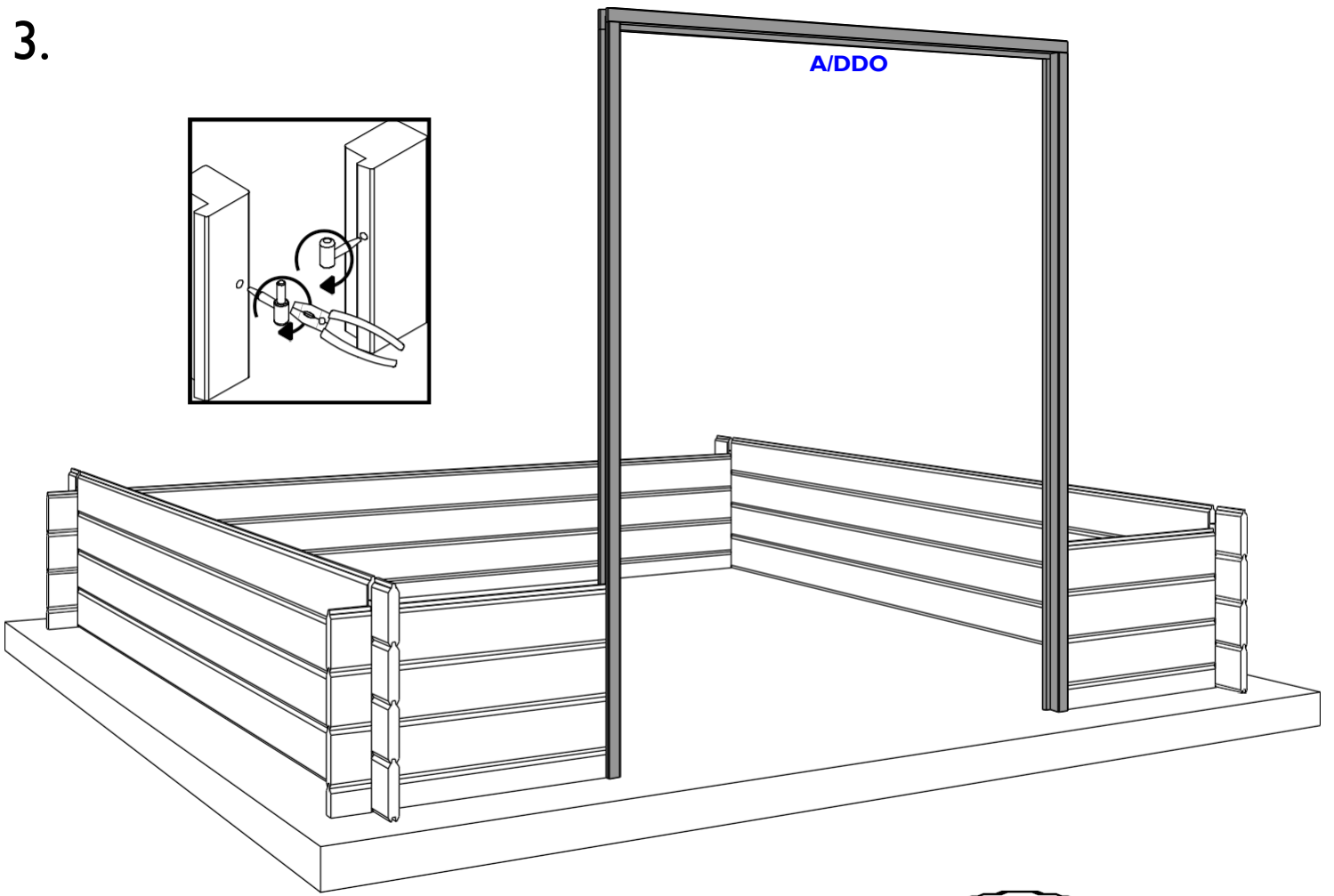

4.

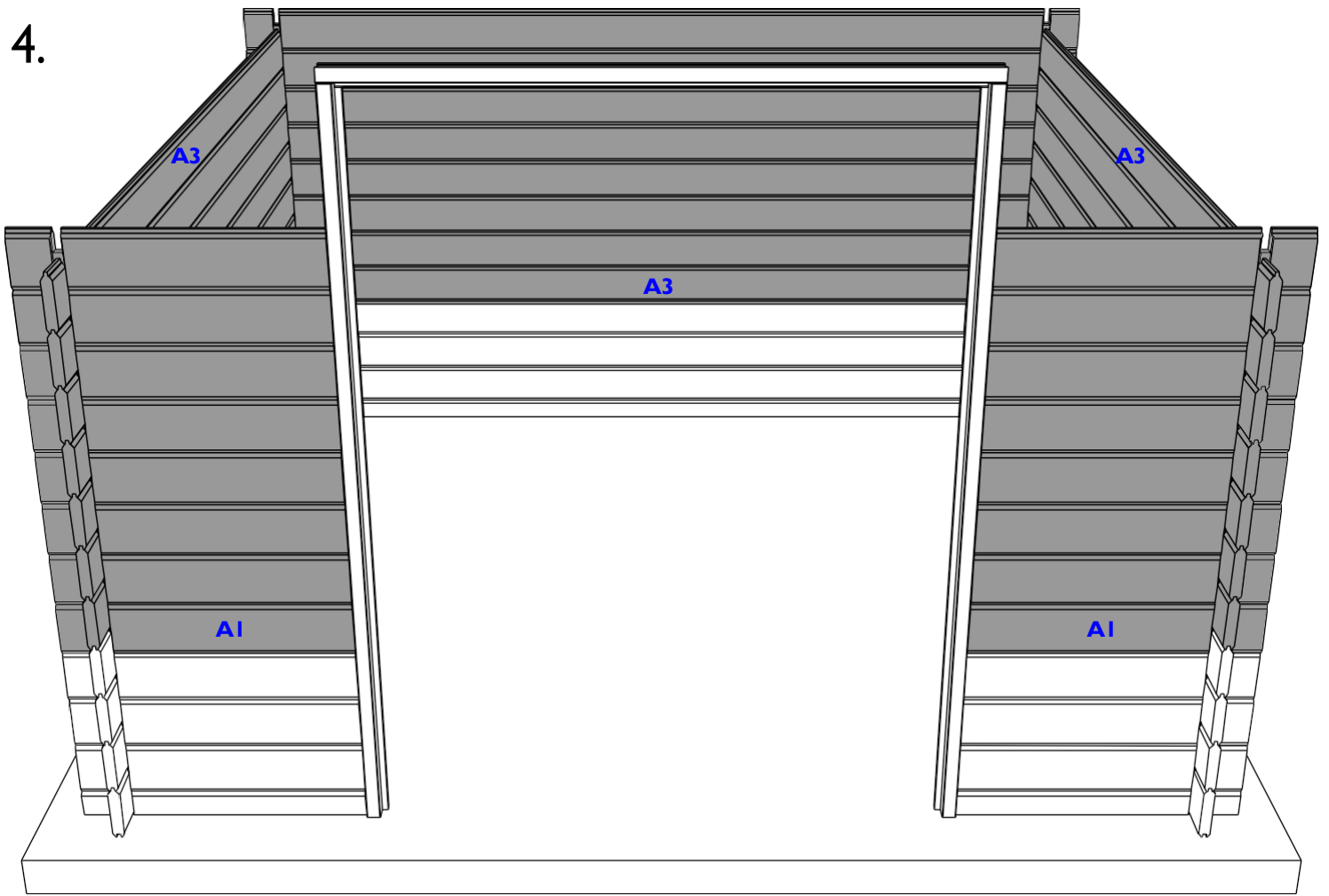

5. Model with window

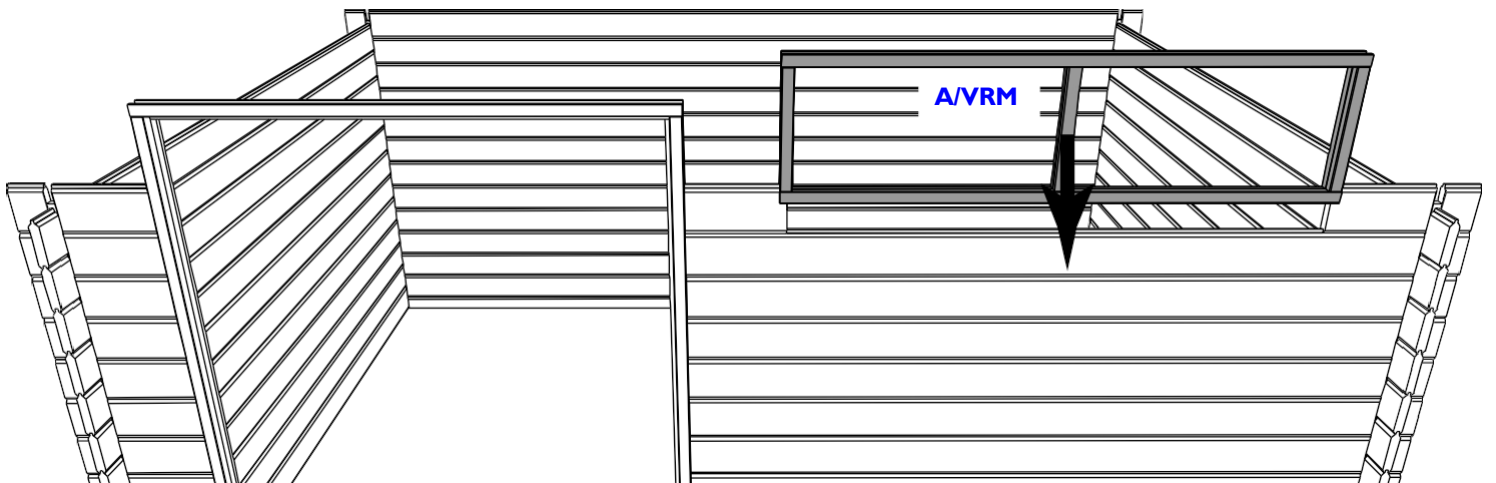
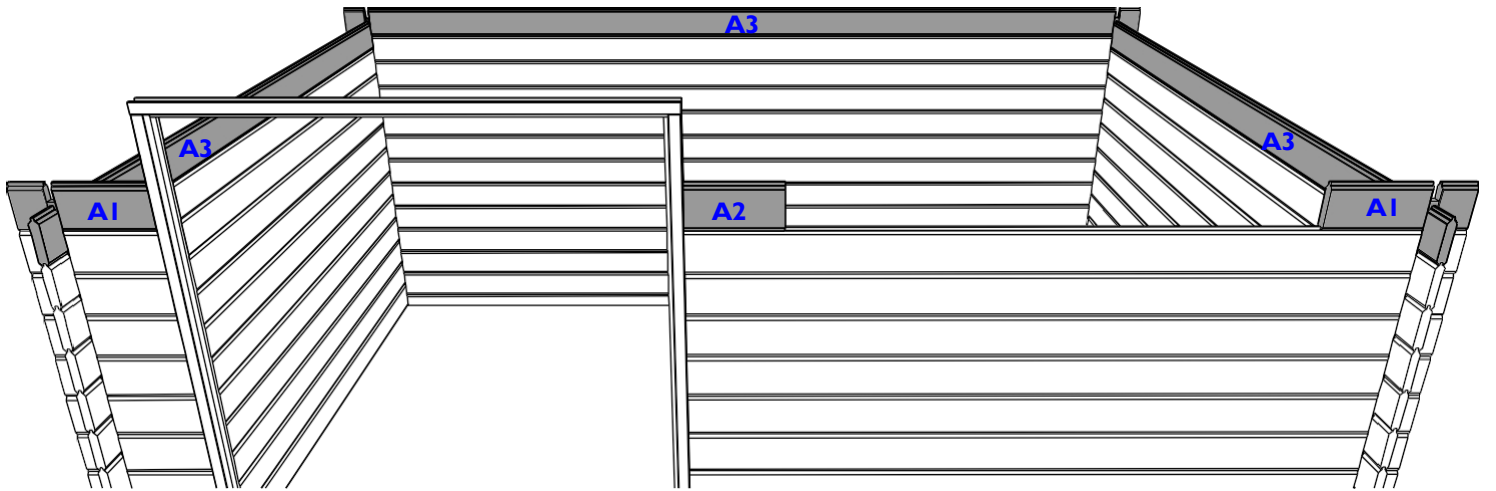

6

6.

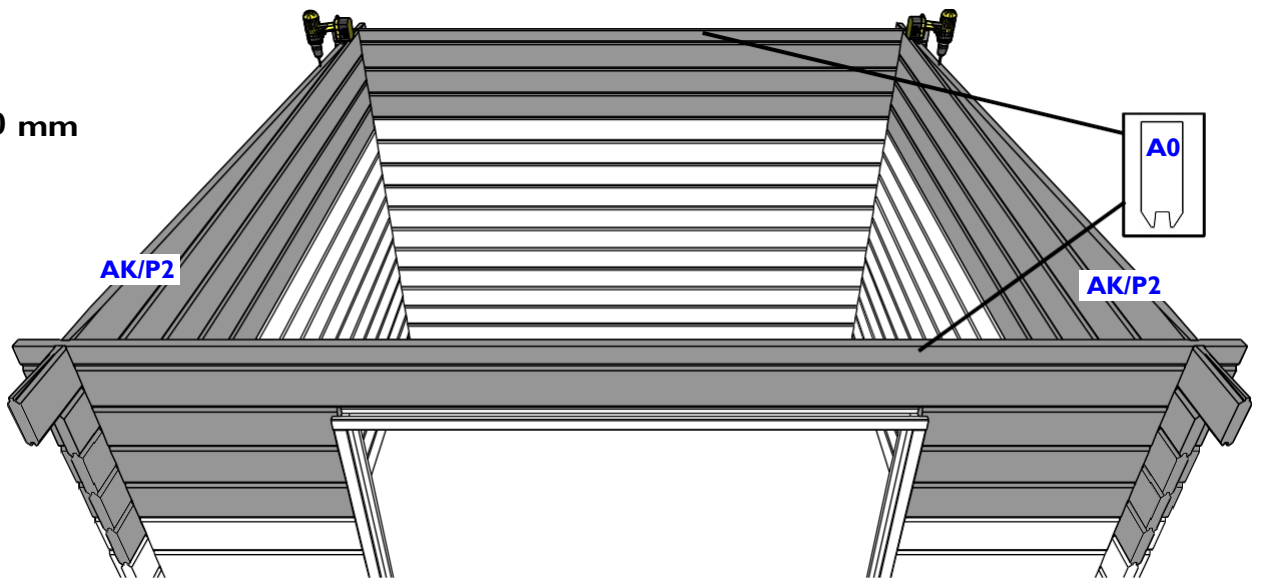
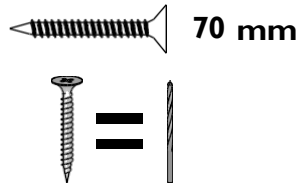

If there are differences in height between the walls, check that the logs fit together properly. To compensate for a height difference (detail A), align the top log with the gable and screw them together (detail B). Now, gently tap the lower logs up one by one (detail C) to distribute the gap evenly across all the logs (detail D).

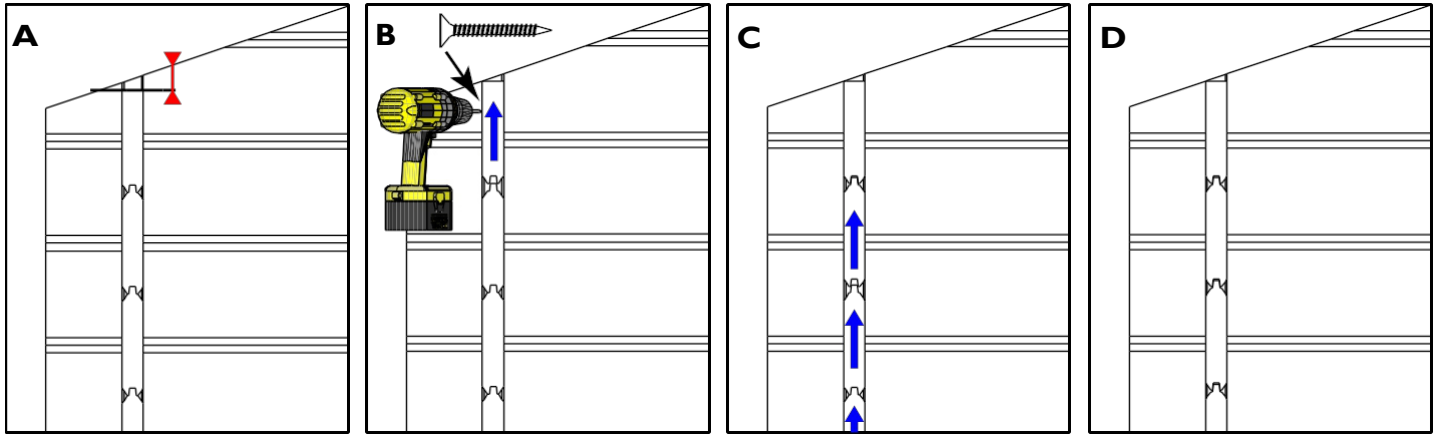

7.

The number of roof rafters in this drawing may differ from the log cabin you have purchased. See the parts list. Distribute all P7/P2 rafters symmetrically across the depth of the log cabin!

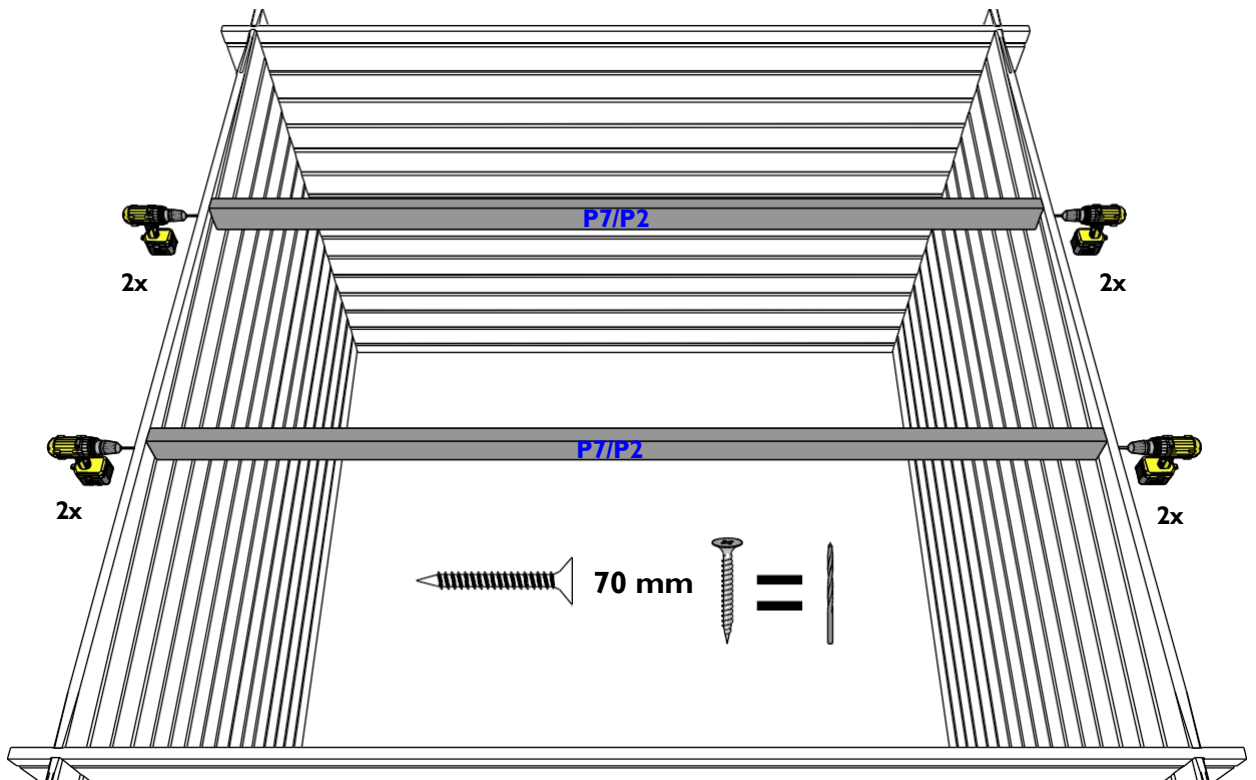
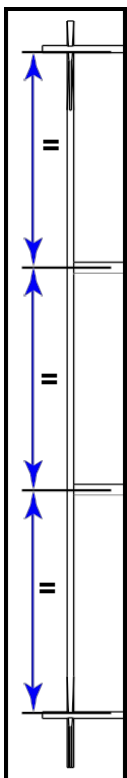

The following instructions apply to models **with extension**. For models **without extension**, please go to point 13.

The drawings show the extension assembly on the right-hand side; mirror the drawing for assembly on the left.

8.

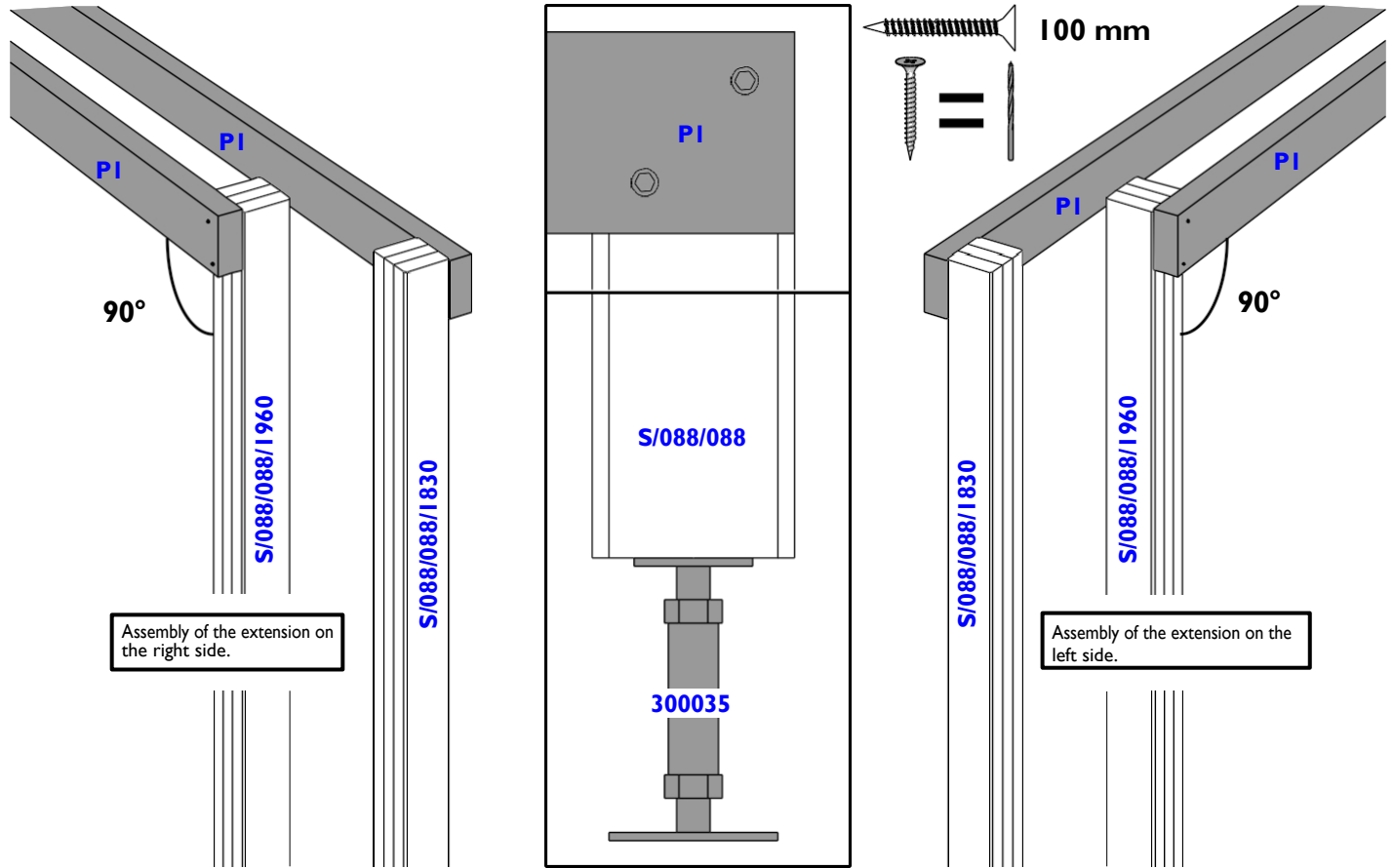

9.

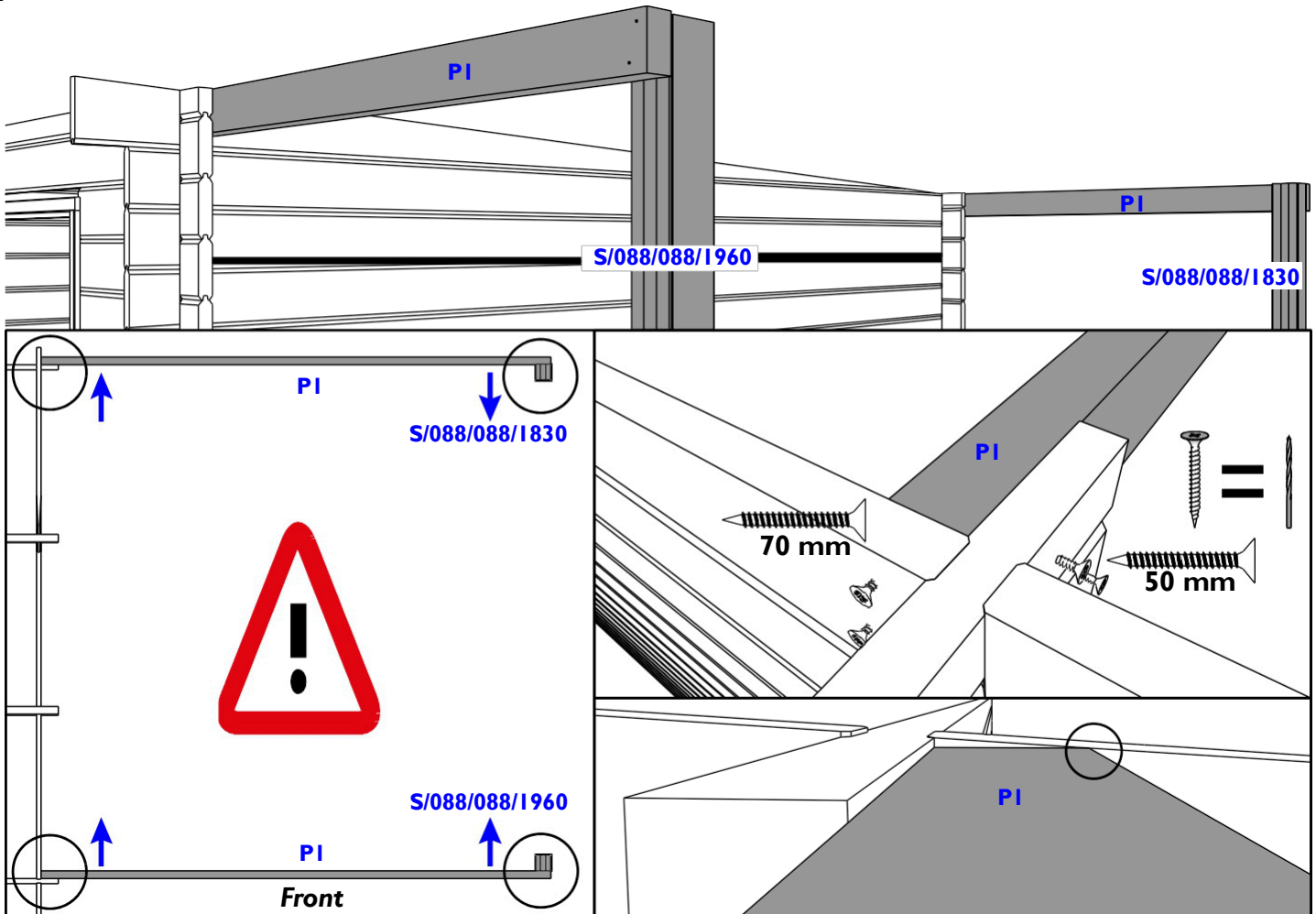

10.

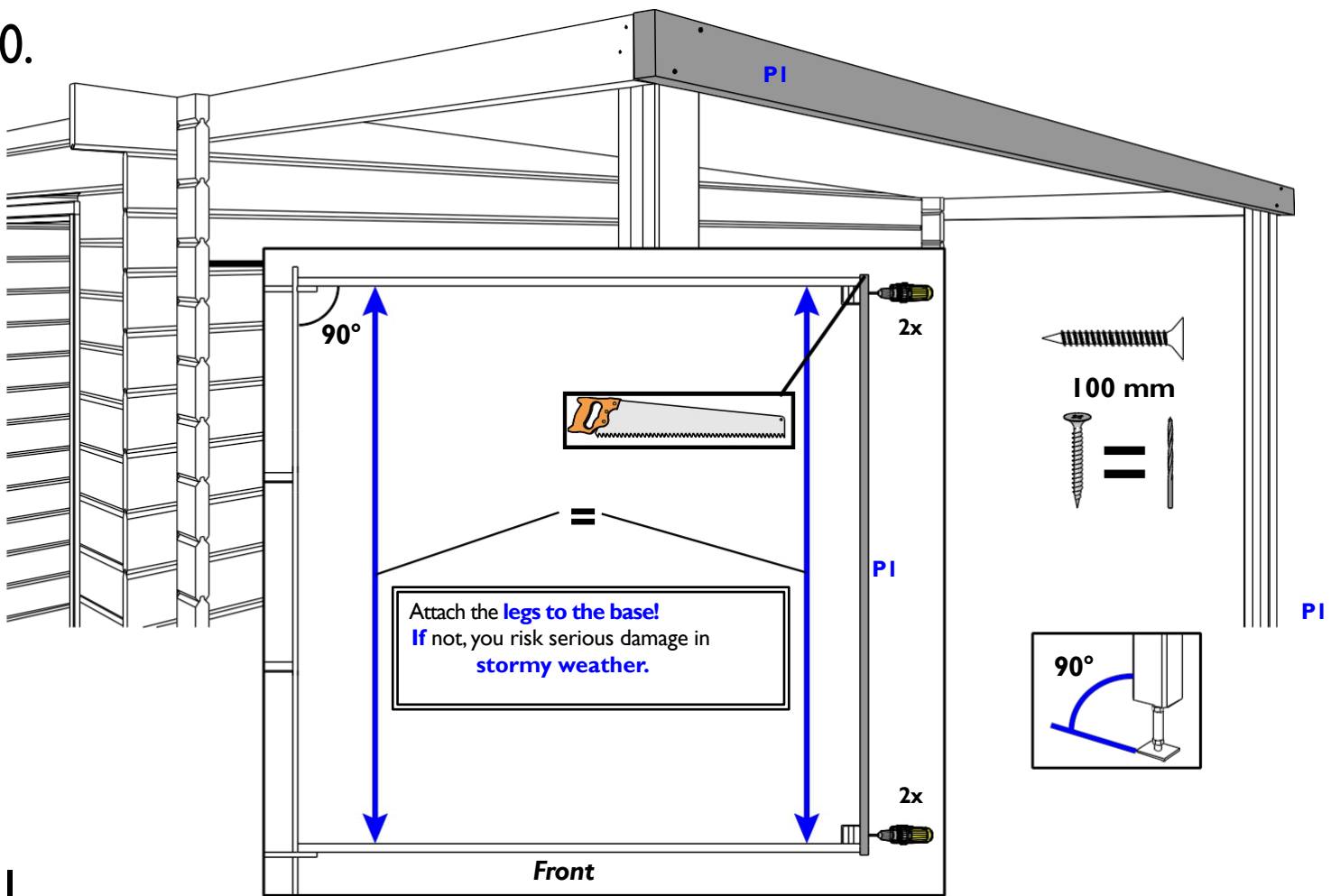

11.

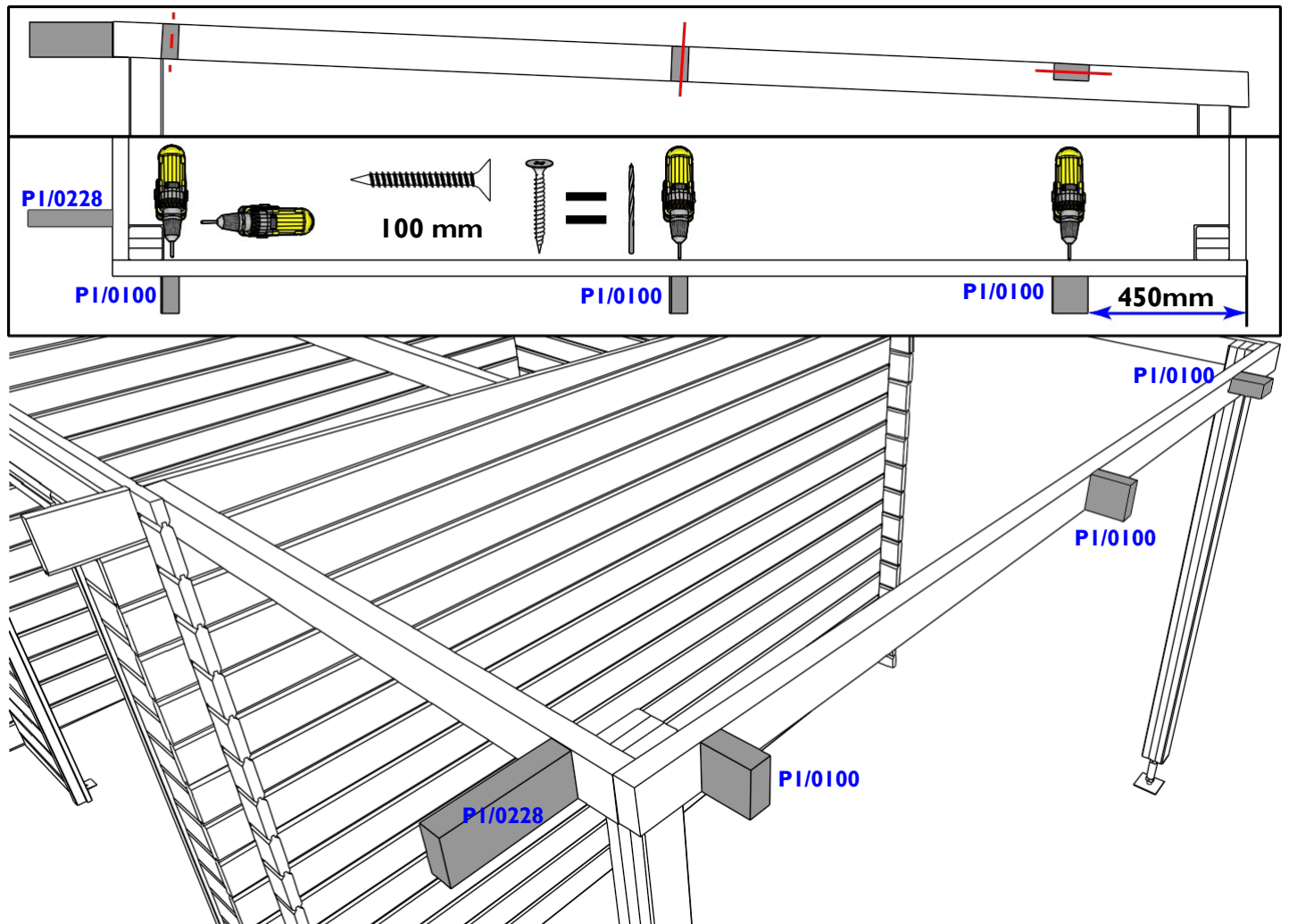

Distribute the additional (depending on the model) support bars P1/0228 symmetrically along the length of the extension! Some models have only 2x P1/0100 on the side. See also the parts list.

12.

The number of roof rafters in this drawing may differ from those in the log cabin you have purchased. See the parts list.
Distribute all P1 rafters symmetrically across the depth of the extension!

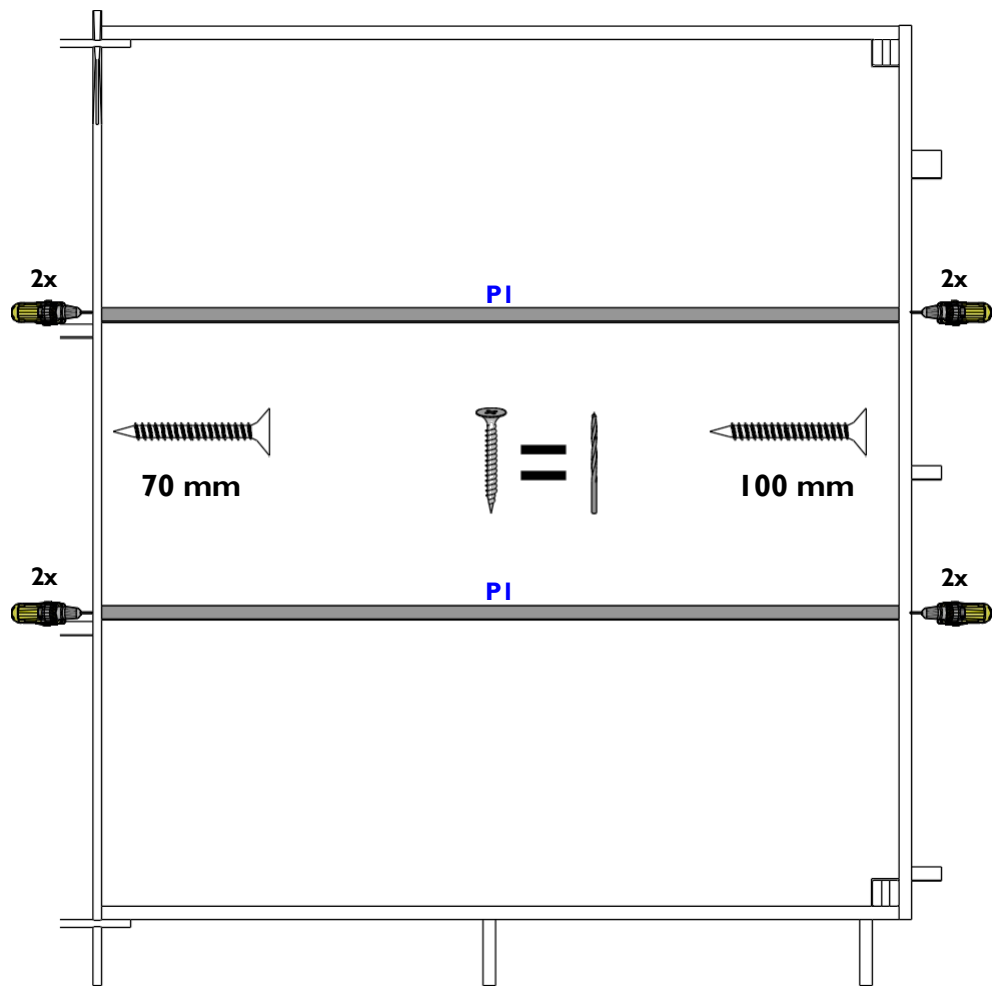

The following instructions apply to all models **with** and **without** extension.

13.

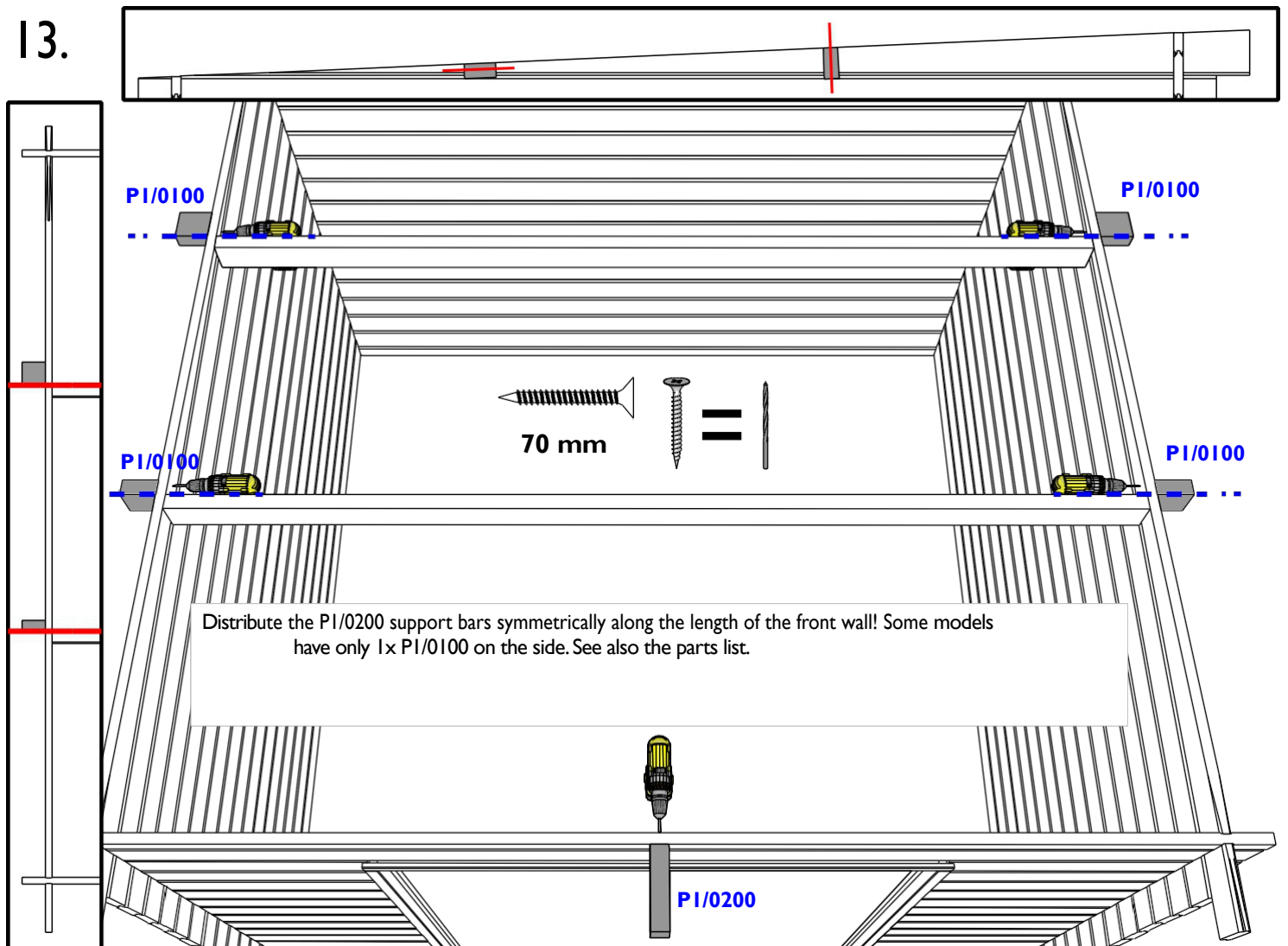

14.

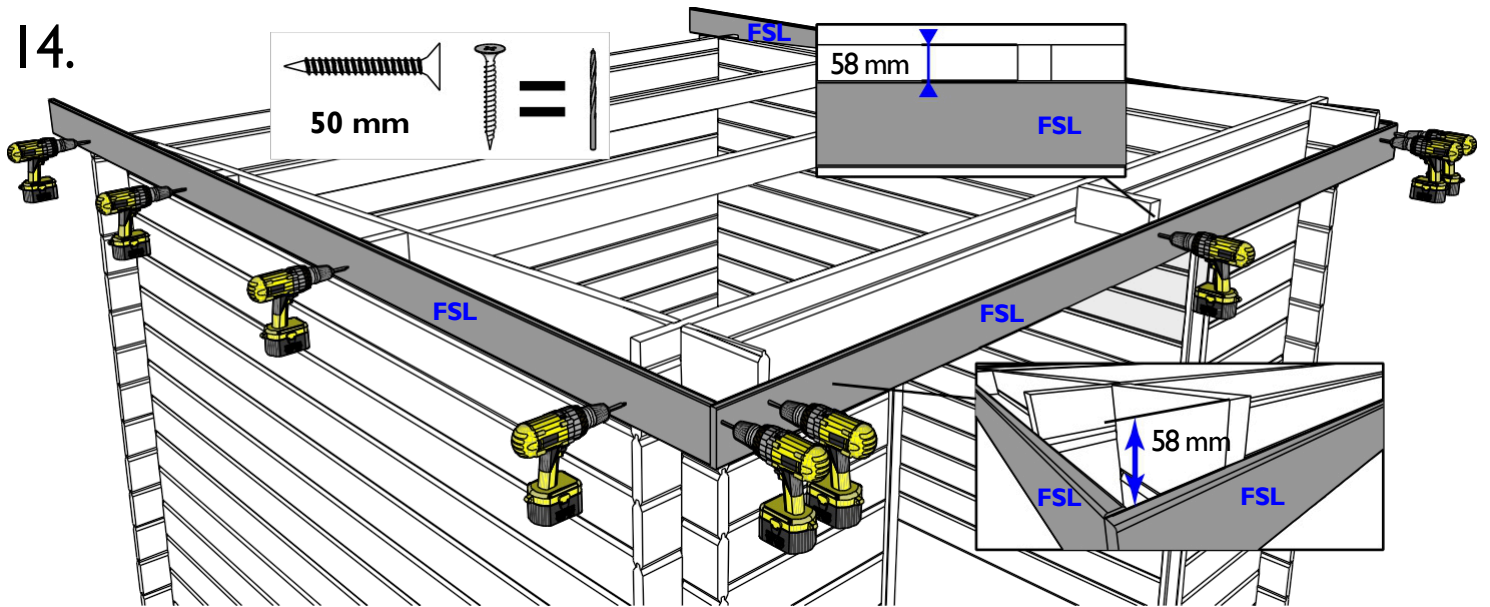

The FSL planks may come in several pieces; saw to length if necessary. See also the parts list.

15.

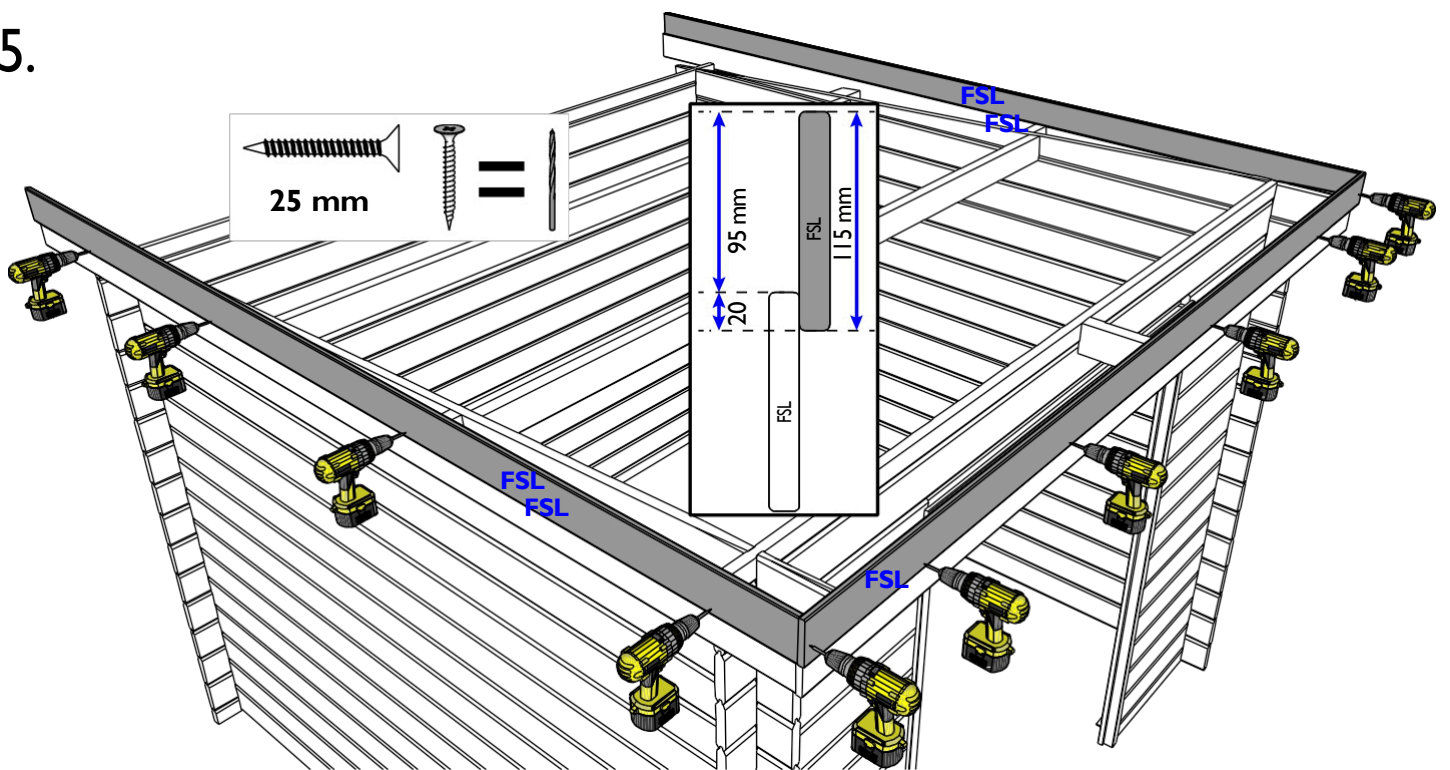

16.

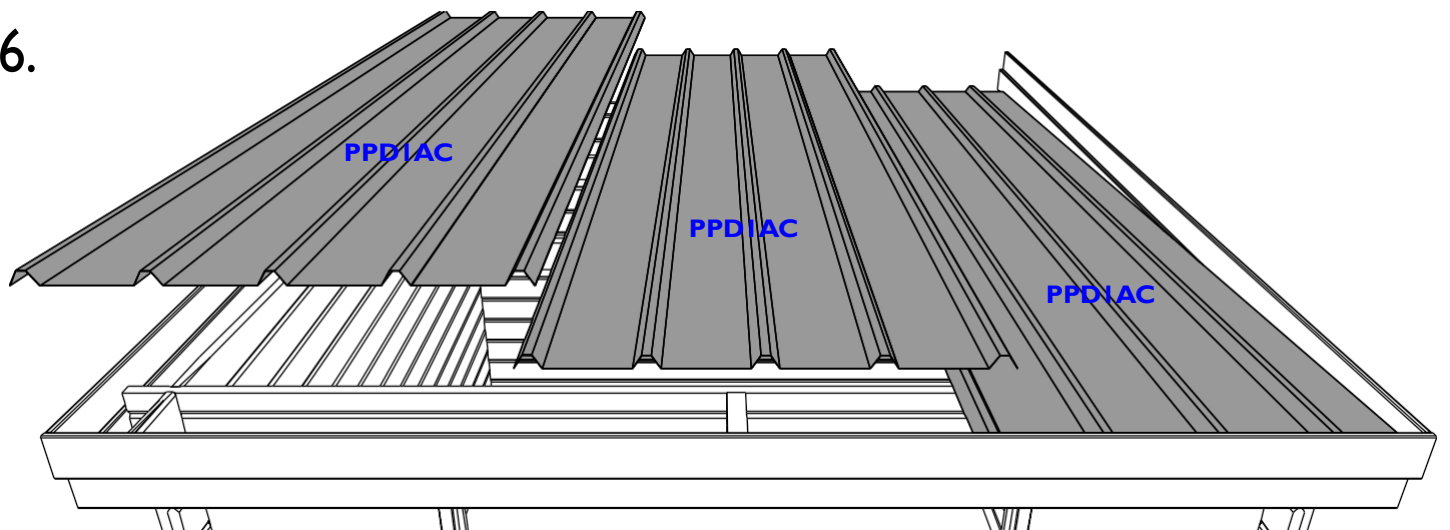

Place the sheets, but **do not** secure them yet! Mark the position of the roof rafters and walls with a pencil. Always start with the sheet cut to width (according to the model). Ensure that the outer corrugation, without the anti-condensation fabric, overlaps the previous sheet.

- 17. Study the drawing below carefully. Repeat the central pattern on each roof beam.**
 Once you have checked that the sheets are perfectly aligned, **pre-drill** with a 5 mm steel drill bit. **Important!** Always drill through a corrugation and never through the flat part of the sheet. **Do not** drill the corrugations marked with a **cross**. Do not forget to remove the iron filings from drilling to prevent rust stains. Use 70mm screws with caps.

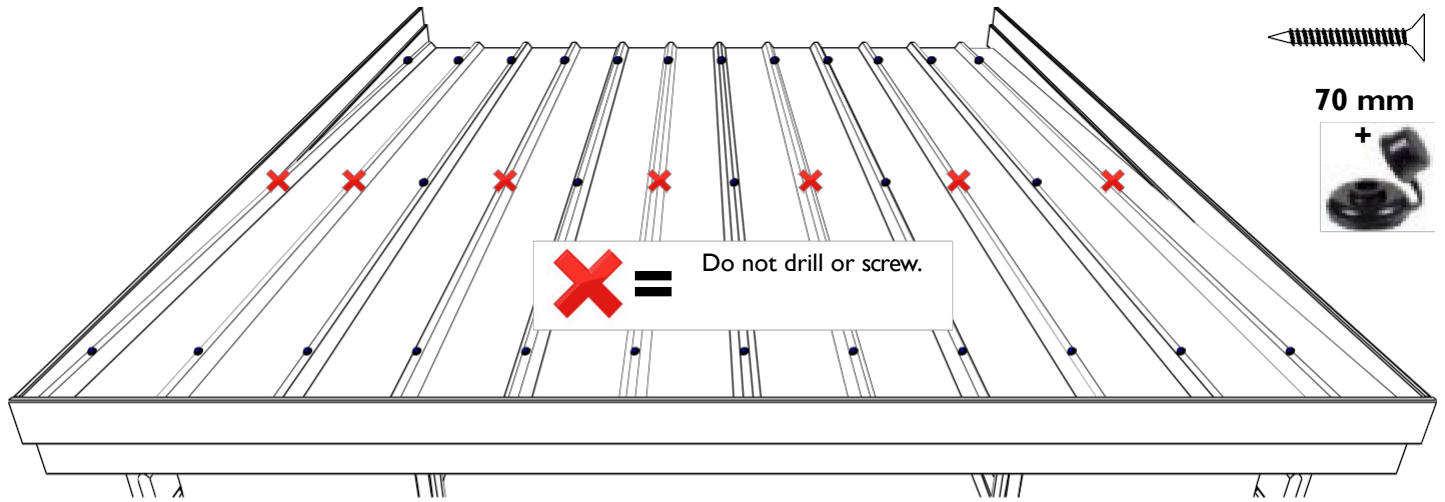

Caution! Impregnate the lower part of the anti-condensation fabric that protrudes **beyond** the rear wall with a clear varnish. This prevents the anti-condensation fabric from absorbing **water** and prevents **moss formation**. If desired, apply a bead of silicone between the frame and the steel sheets.

18.

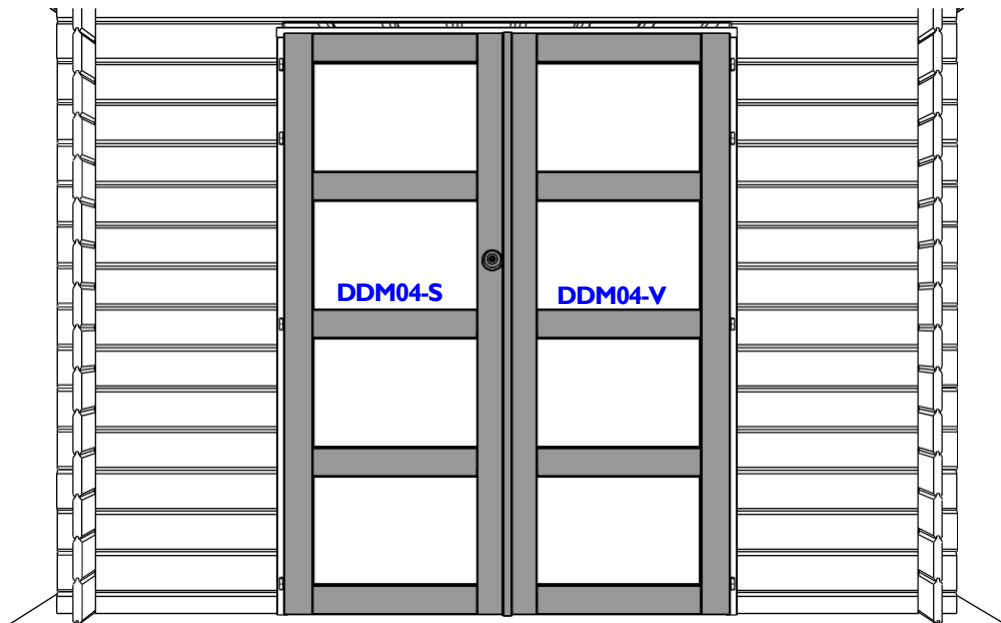

During the year, the door may not close properly. You can easily adjust it using the hinges.

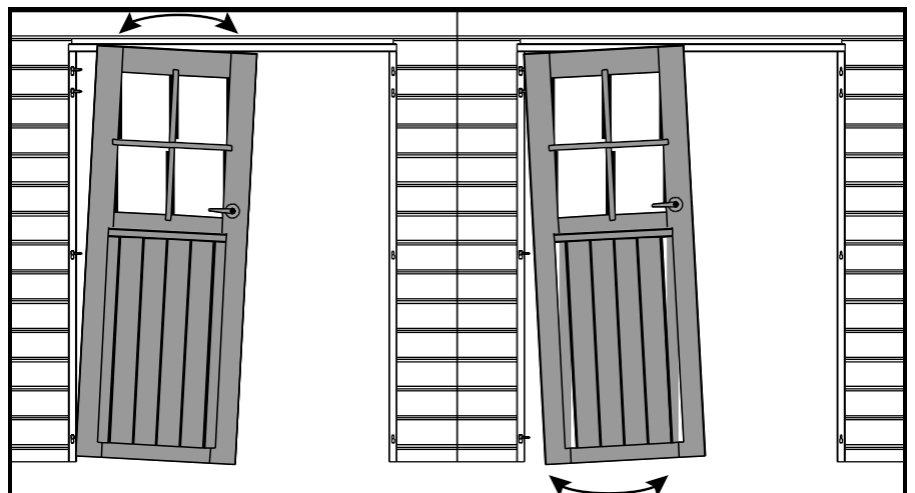
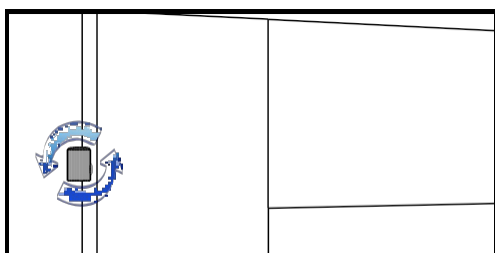

19.

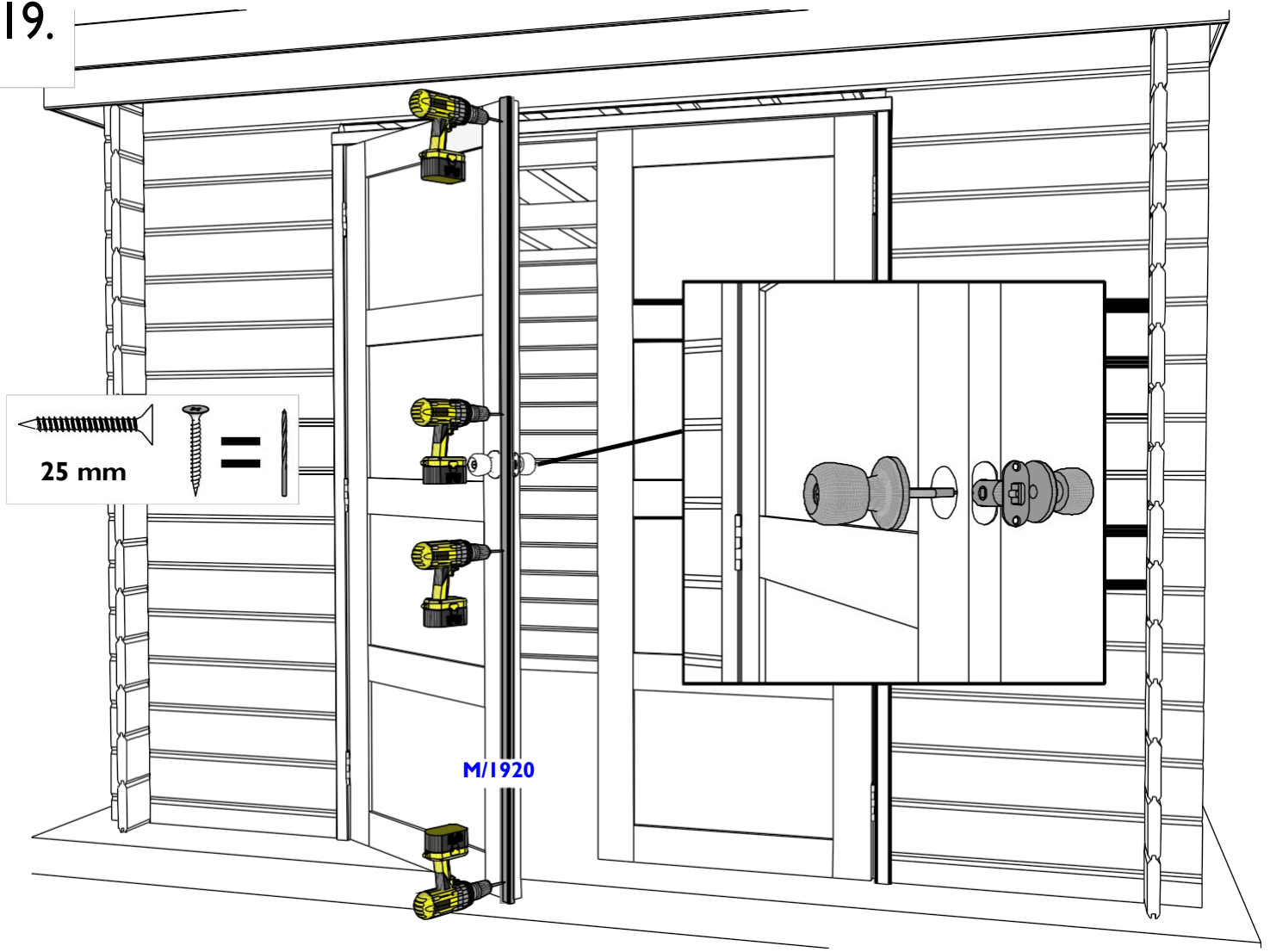

20.

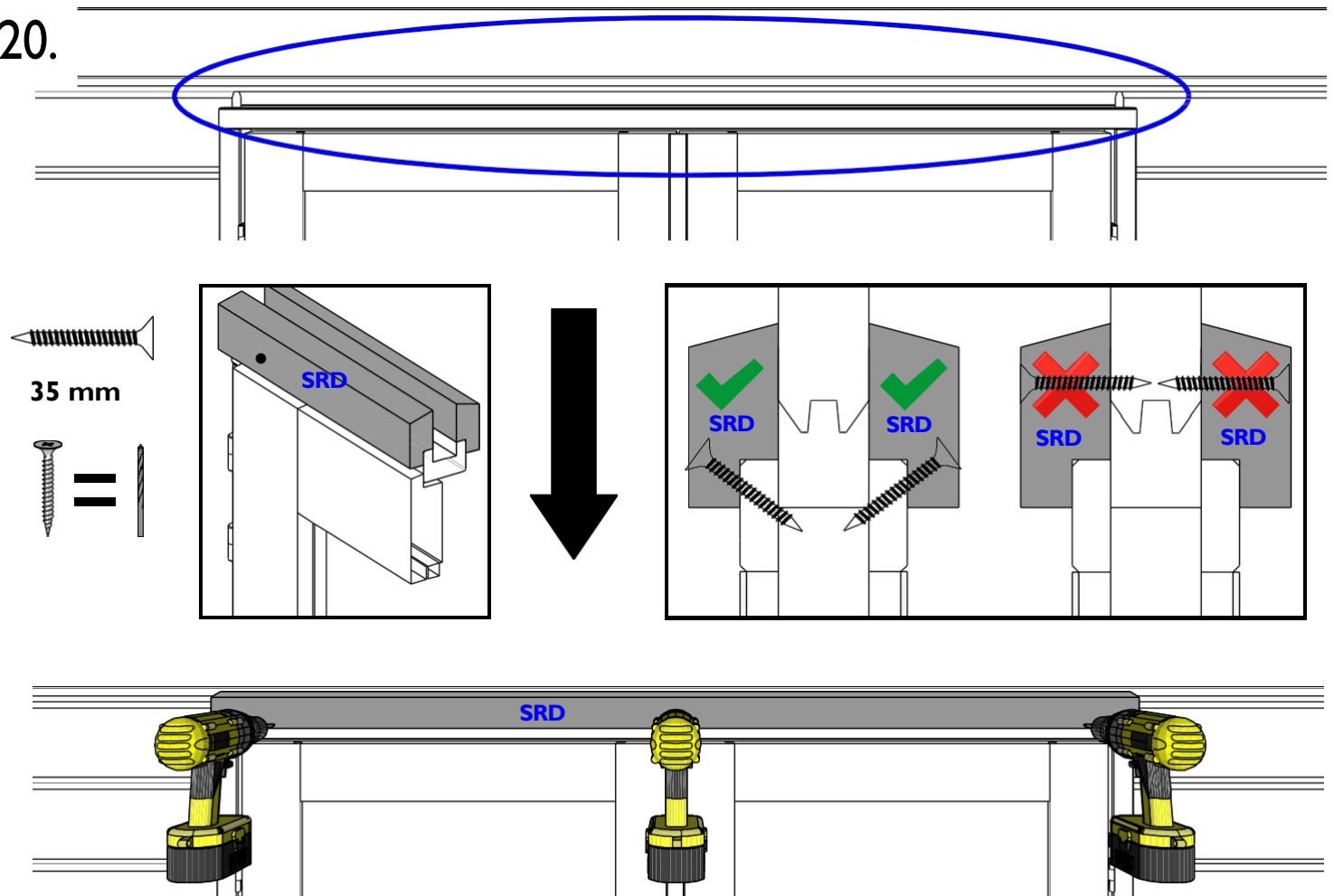

21.

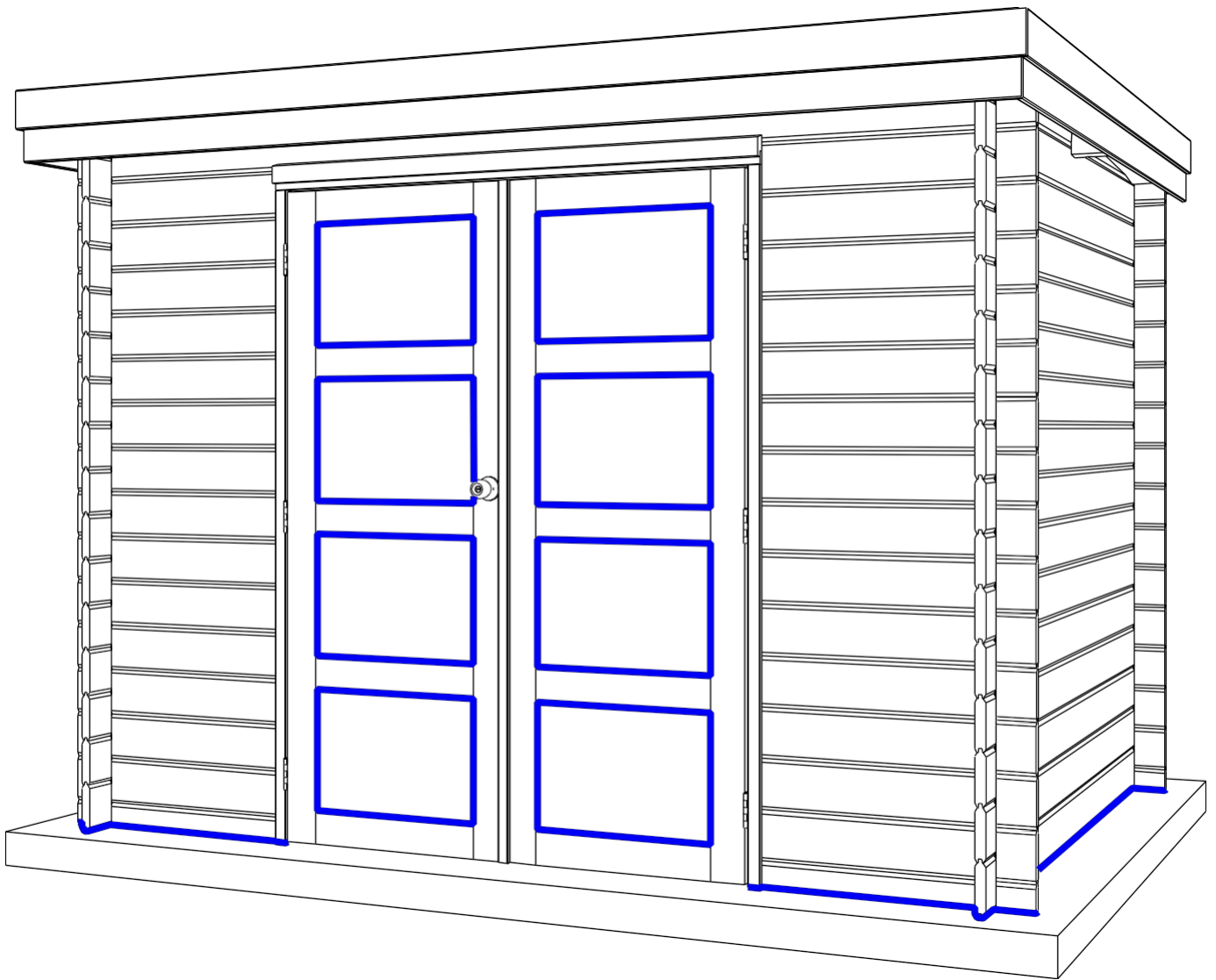

Seal the following areas with silicone (not supplied):

- The joint between the log cabin and its base on the outside,
- Around the glass.



To make your log cabin storm-resistant, you will need to install storm bracing. This connects the roof and walls to the base. So make sure it is properly secured to the ground. Always ensure that you do not obstruct vertical shrinkage and expansion (see 'Wood lives'). Gardenas dealers sell our standard storm bracing. An alternative is to attach a screw to both the top and bottom logs and stretch a nylon cord between them. In any case, you must ensure that the force of the storm bracing does not cause the wall to bulge. If this were to happen, you must adjust the bracing.

Maintenance: water, wind, snow and sun are the main enemies of your log cabin. Seek advice from a specialist if you have any questions about products, timing, etc. for treatment.

Product liability applies only if the log cabin has been assembled in full compliance with these assembly instructions.

Options

Rear wall

1.

Fasten the battens to the roof; the bottom of these battens must not touch the ground.

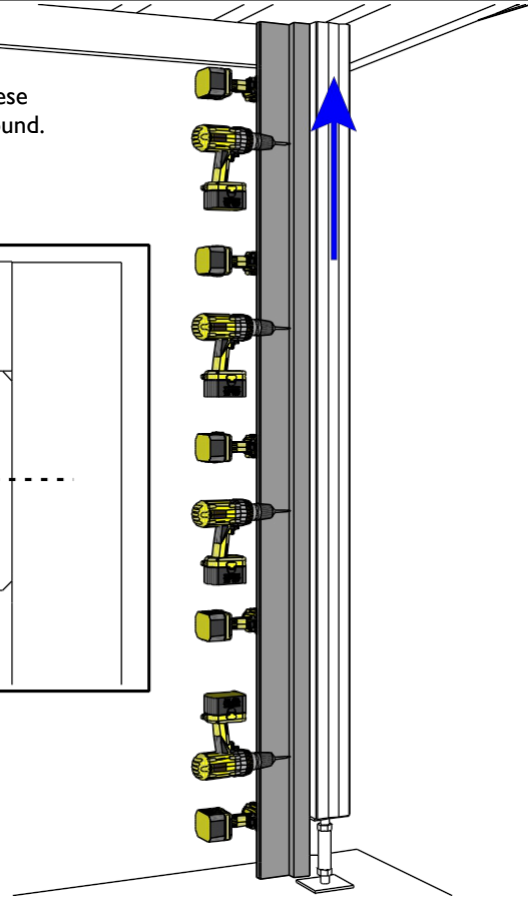
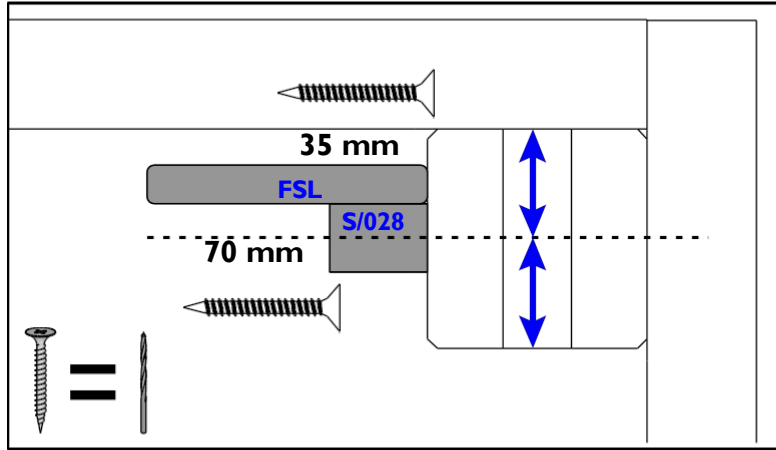

2.

Start at the bottom. Screw through the rear wall of the log cabin into each A2 and A5L. **Please note!** Do not screw on the side of the post.

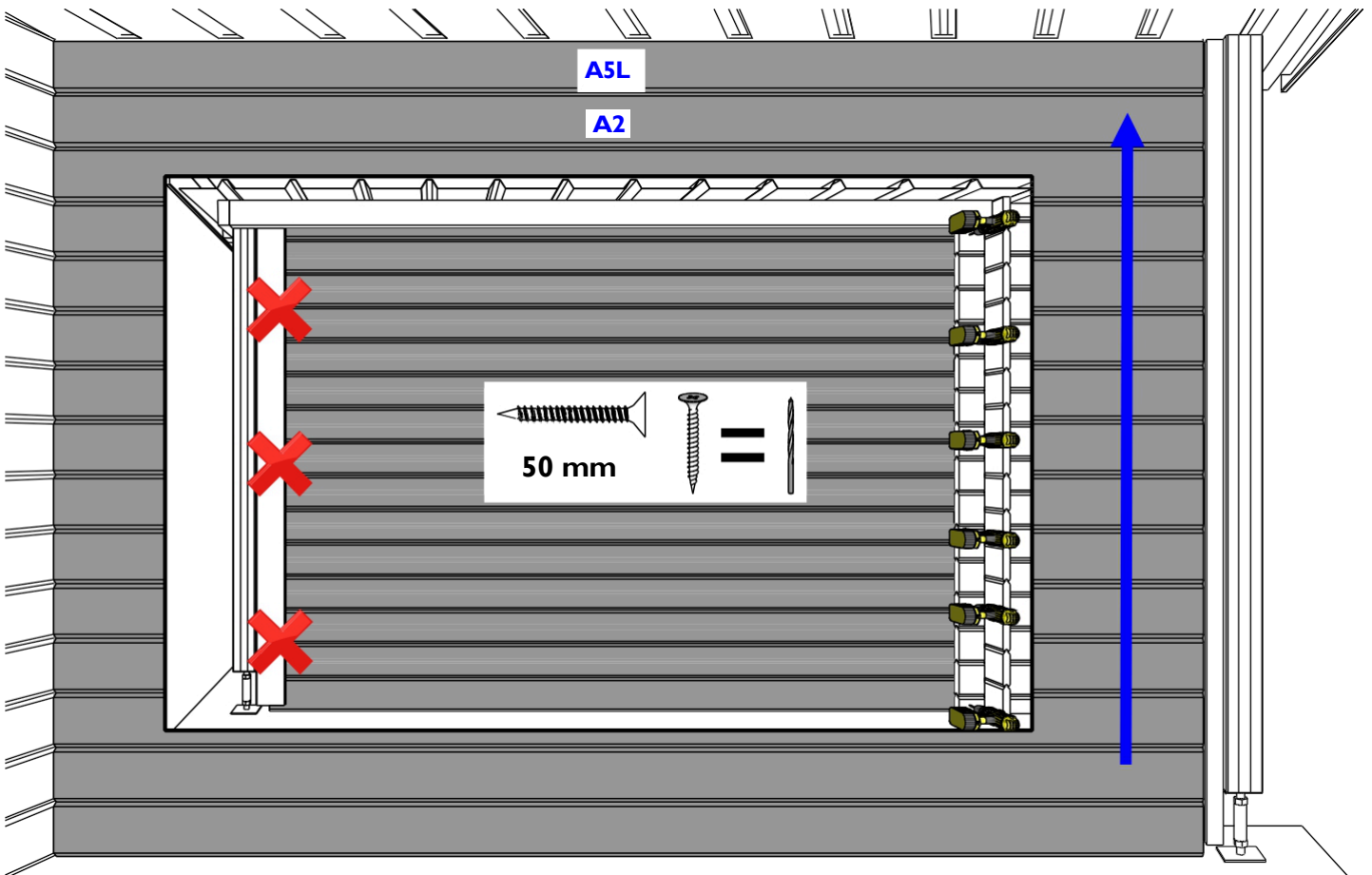

3.

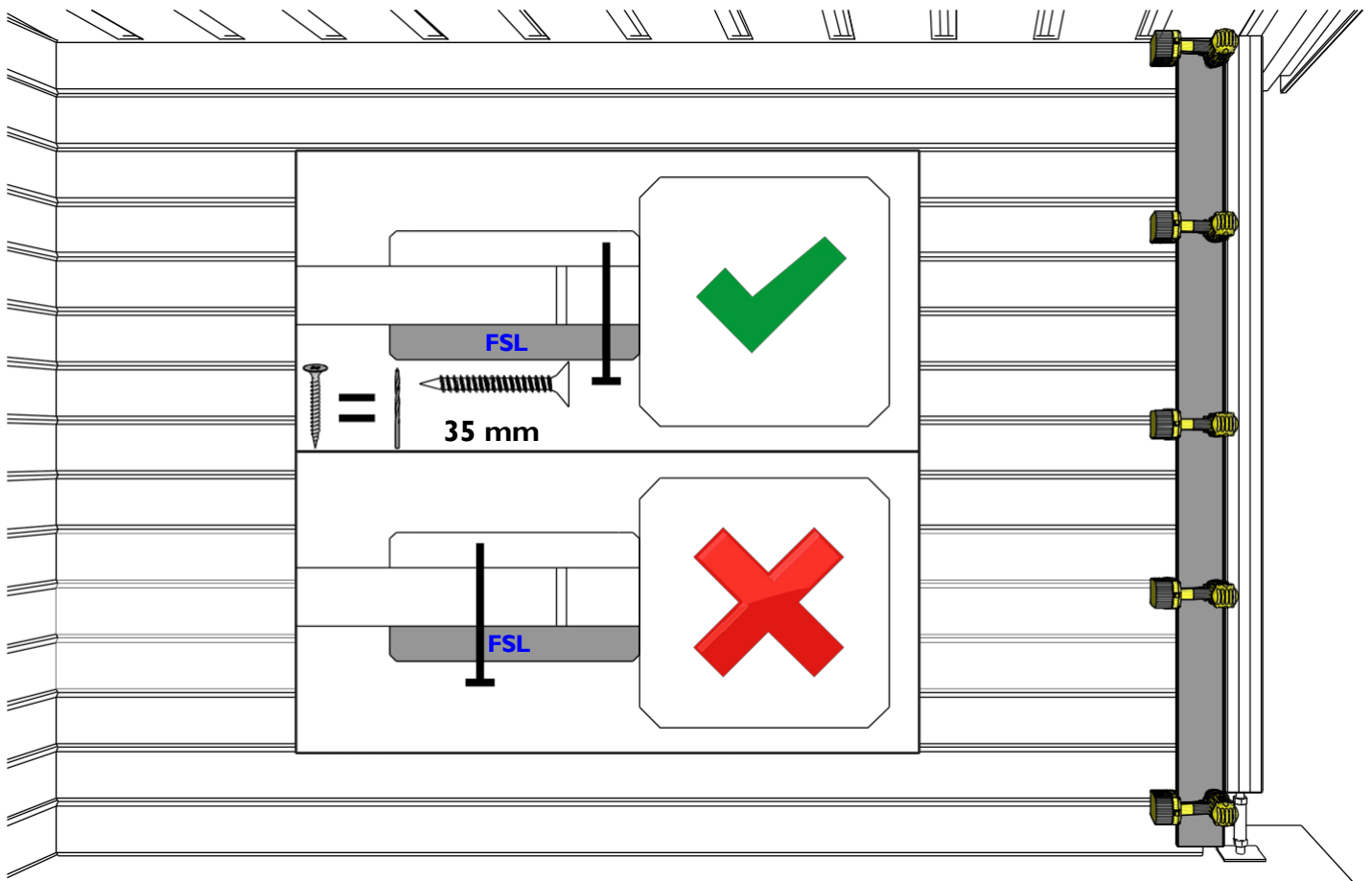

Side wall

Start at the top, beneath the joint. Ensure that you can see an equal amount of the post on both the left and right sides. Use the plastic shims provided to create a **2mm** gap between the logs. **If you do not do this, the logs will not be able to expand and contract, and you risk the logs detaching from the posts, resulting in serious damage.** Screw each log.

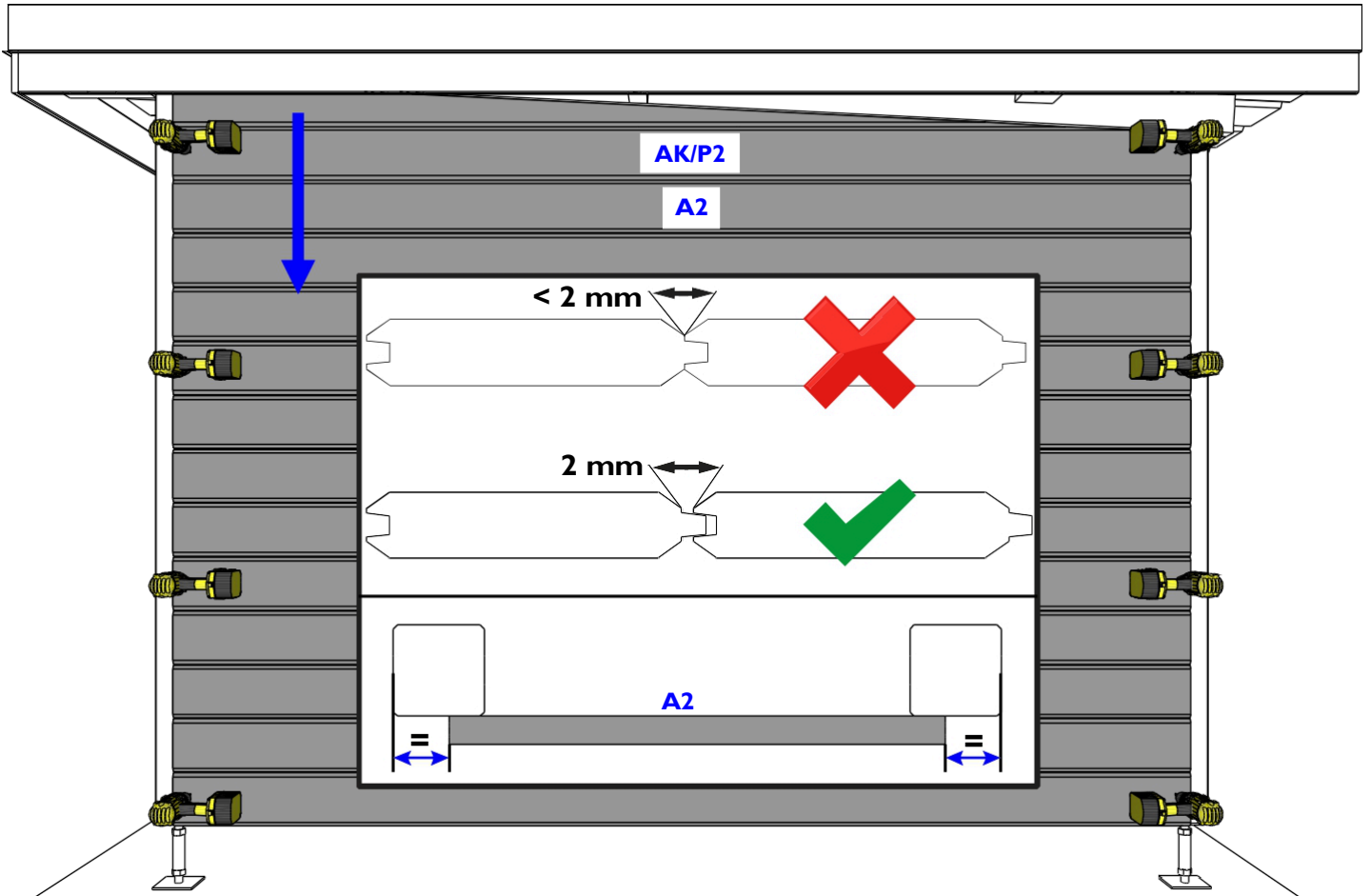

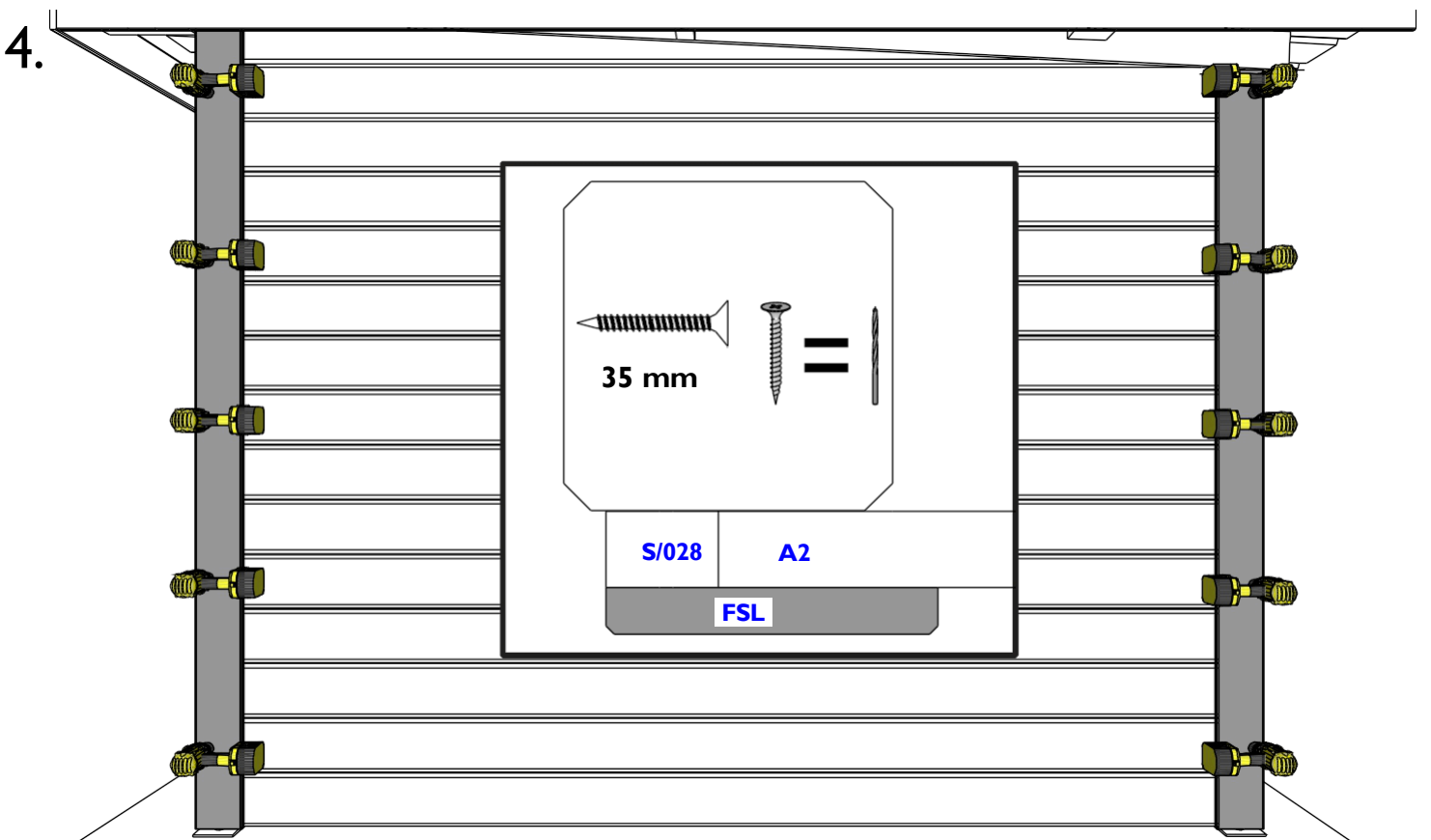
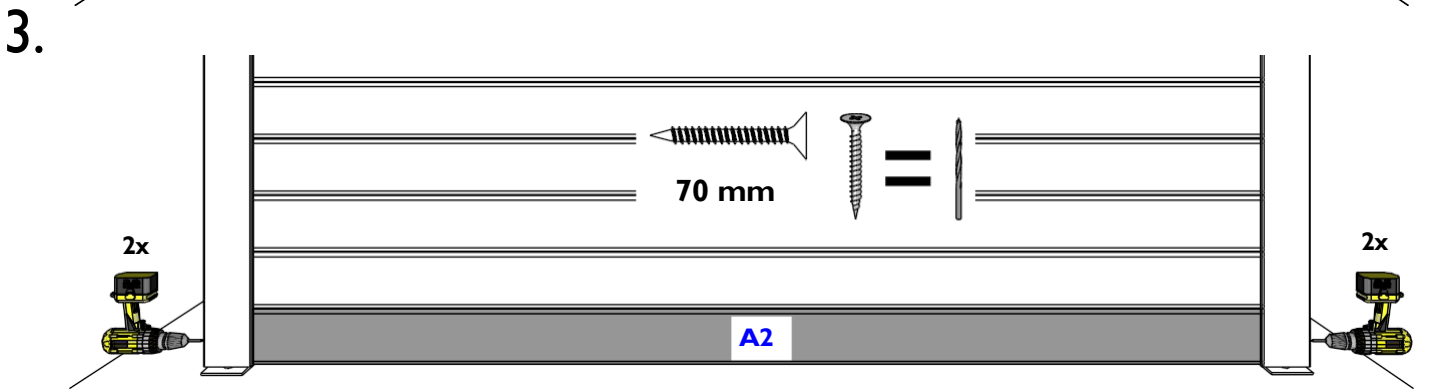
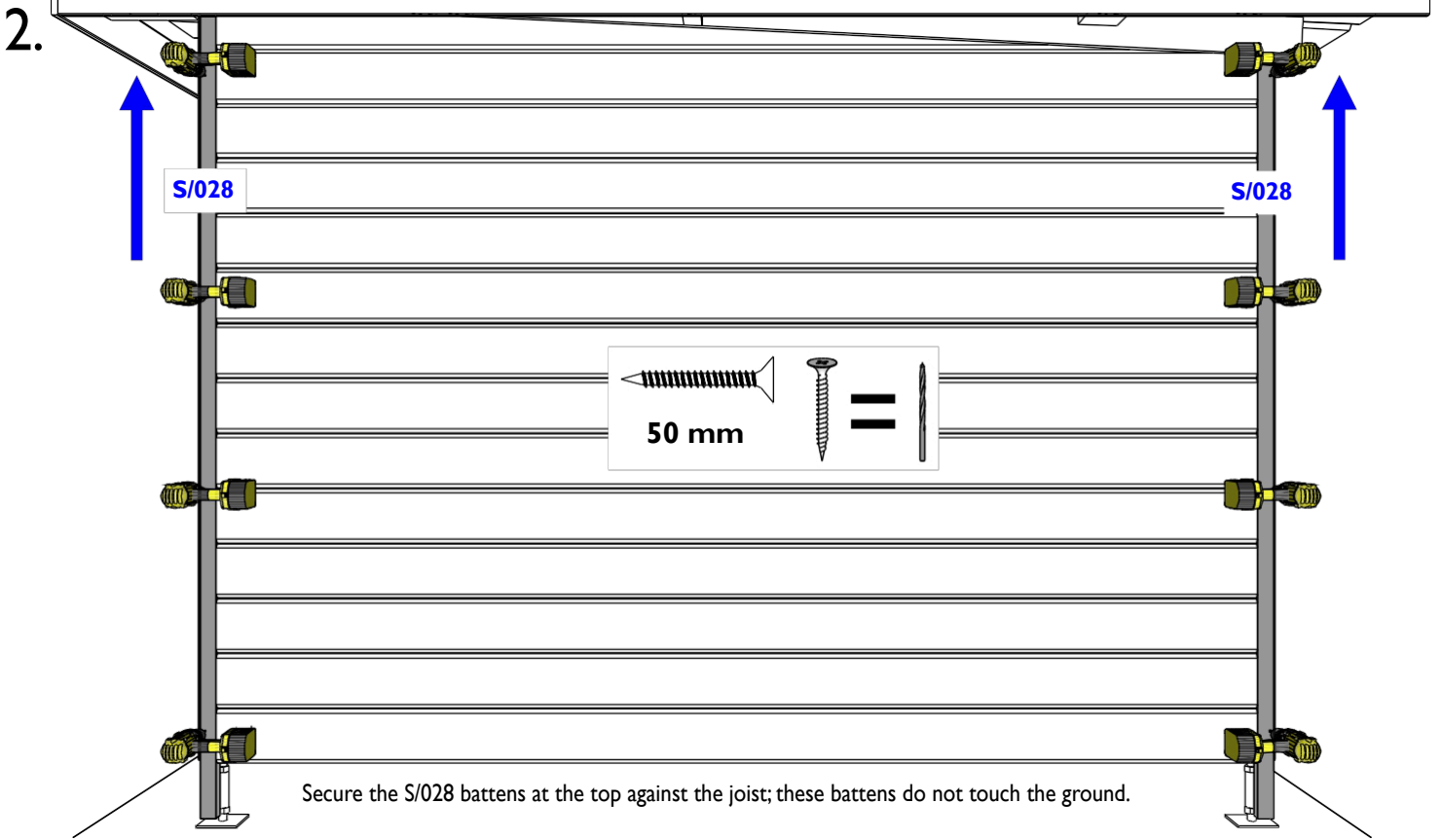

WARRANTY

The product is made of wood, a natural product that, due to its outdoor placement, will continue to "live" and therefore requires ongoing attention. Assembly, treatment and anchoring will be carried out by or on behalf of the customer. Gardenas is therefore responsible for and provides a warranty on the product and its components themselves, but not for the consequences of incorrect assembly, missing or inadequate anchoring, or incorrect or inadequate maintenance.

How long?

Unless otherwise stated, Gardenas offers a 5-year warranty on its products. Fittings and roofing are covered by a 2-year warranty. Products sold as pressure-impregnated are covered by an extended 10-year warranty against rot, mould and insect damage to the wooden parts.

The warranty period starts from the date of purchase.

What is covered by the warranty?

- The structural design of the product for safe and normal use.
- The correctness of the parts in terms of quantity and shape upon delivery. Any deviations must be reported no later than 14 days after delivery.
- The warranty is limited to the replacement of defective, damaged or unusable parts.

What is not covered by the warranty?

- Costs of (re)installation, production, assembly, treatment.
- Parts that are no longer in their original condition.
- Defective parts that were installed anyway.
- Minor deviations from the natural material, whether or not specified in the manual, which do not compromise the stability and expected lifespan of the product (e.g. knots, cracks, discolouration, slight deformations that can be assembled and will have no impact after assembly or will be invisible after assembly, etc.).
- Damage, deformations or defects resulting from ignoring to strictly follow the advice and instructions in the product manual and/or incorrect or careless use of the product, as well as damage caused by poor foundations.
- Damage and degradation and their consequences due to inadequate treatment of the product.
- Damage caused during transport and storage, whether or not due to extreme humidity, if transport and storage were not carried out under Gardenas' management.
- Damage caused by third parties, animals, insects (except if the product was delivered pressure-impregnated) and termites.
- Natural ageing or discolouration of the product.
- Damage caused by a roof load (e.g. snow) of more than 50 kg/m².
- Direct or indirect damage to items and materials stored in or under the product.
- Consequences of force majeure: storms, natural disasters, floods, vandalism, etc.

Parts availability and delivery

Gardenas guarantees the availability of all parts or a valid alternative for each part for up to 5 years after purchase of the product, regardless of whether the part is still under warranty or not.

Gardenas will make every effort to provide any replacement parts as quickly as reasonably possible. Gardenas will deliver the parts in the same manner and to the same location as it delivered the original product.